

**APPENDIX C**  
**CLOVERDALE PAINT EMERGENCY RESPONSE MANUAL**

INTEGRITY  
INNOVATION  
PERFORMANCE

A large, light gray, stylized fan graphic is positioned in the center of the page. It consists of multiple overlapping, curved segments that radiate from a central point on the left side, creating a sense of depth and movement.

# EMERGENCY RESPONSE MANUAL

# TABLE OF CONTENTS

Section 1	Description of the Buildings Complex
Section 2	Functions of the Buildings Complex
Section 3	Owner of Buildings Complex
Section 4	Emergency Phone Numbers
Section 5	Emergency Organization and Notification Procedures
Section 6	Emergency Shut-down Procedures
Section 7	Emergency Evacuation Procedures
Section 8	Emergency Response Information
Section 9	Flammable Goods Storage
Section 10	Building Fire Fighting Facilities
Section 11	Fire Protection Systems and Equipment Maintenance
Section 12	Appendixes
	Appendix A - Equipment Location and Capabilities Charts
	Appendix B - Tank Farm Drawing
	Appendix C - Flammable Piping Drawing
	Appendix D - Flammable Good Storage
	Appendix E - Raw Materials Lists

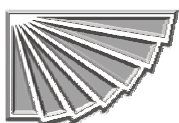

**1.0 Description of Buildings**

- 1.1 Consists of a manufacturing area, a R & D laboratory and an office area in a single story structure with an office area mezzanine which covers approximately 75,000 feet.
- 1.2. A warehouse/distribution facility, of approximately 21,000 square feet, is located on the north side of the property.
- 1.3 A tank farm is located on the northwest section of the property which covers an area of 8,965 square feet.

**2.0 Functions of the Buildings Complex**

**2.1 Products Manufactured**

Industrial Coatings, Sealants and Polymers.

**2.2 Office Area**

Administration and Sales.

**2.3 R & D Laboratory**

Serves personnel and equipment related to research and development of product lines.

**2.4 Plant Area**

Serves personnel and equipment related to manufacturing and packaging, receiving and storage of raw materials, storage and shipping of finished goods and maintenance of production equipment.

**2.5 Warehouse/Distribution Facility**

Serves as a storage facility for raw materials and storage and shipping of finished goods.

**2.6 Raw Material Tank Farm**

- 1. Drawing in Appendix B.
- 2. Located outside at the north side of the building.
- 3. Various solvents and polymers utilized in the manufacturing of product lines.
- 4. Tanks are located within a separate diked enclosure.
- 5. Tanks are piped and valved to ensure that in the event of a tank rupture the spill will be contained within the enclosure.
- 6. Thirteen remotely operated pumps located within the enclosure serve as raw materials transfer pumps.

**2.7 Pressurized Bottle Storage**

Located outside of the maintenance shop.

**2.8 Propane Tank Storage**

Located outside in metal enclosure by Receiving doors.

**3.0 Owner of the Building Complex**

The Building is owned by Cloverdale Paint Inc.

**4.0 Emergency Phone Numbers**

**4.1 Emergency & Important Phone Numbers, non-Company**

- |  |              |
|--|--------------|
| 1. Ambulance/Paramedics; Emergency     | <b>9-1-1</b> |
| 2. Ambulance/Paramedics; Non-emergency | 204-986-6336 |
| 3. Fire Department; Emergency          | <b>9-1-1</b> |
| 4. Fire Chief's Office (Non-emergency) | 204-986-4081 |
| 5. Police Department; Emergency        | <b>9-1-1</b> |
| 6. Police Department; Non-emergency    | 204-986-6222 |
| 7. Impact Security Group               | 204-953-1965 |



**EMERGENCY RESPONSE MANUAL**  
**Cloverdale Paint Inc.**

Revision #: 10

July 2013

- |   |              |
|---|--------------|
| 8. Hospital (St. Boniface General)  | 204-233-8563 |
| 9. Hospital (Health Sciences Center)  | 204-774-6511 |
| 10. Poison Control Center (HSC)   | 204-787-2591 |
| 11. Environmental Protection Operations<br>(Environmental Emergencies - spills) | 204-944-4888 |

**4.2 Emergency & Important Phone Numbers, Company**

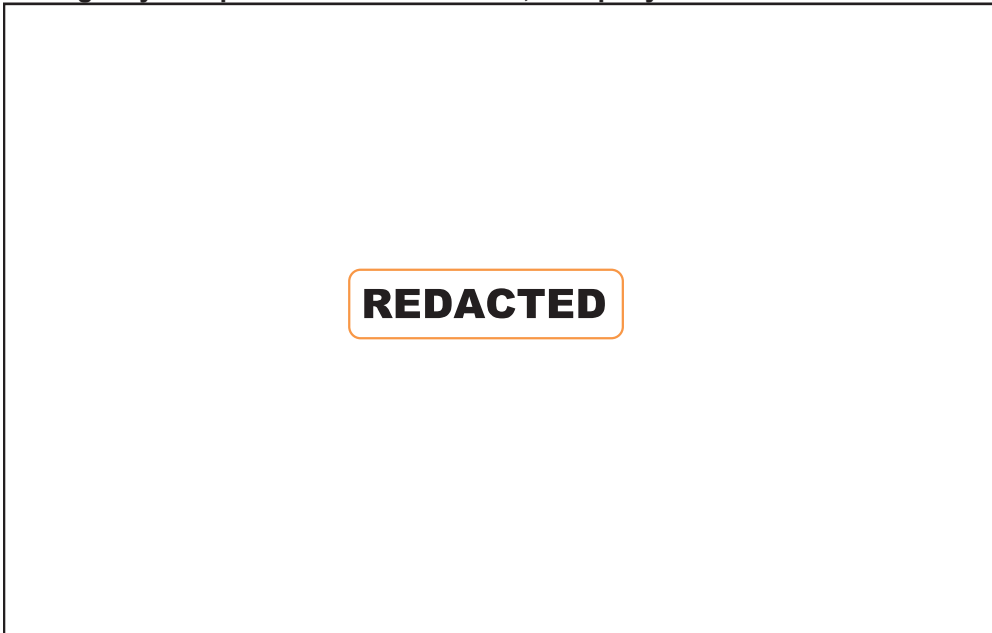

**4.3 After Hours Emergency Numbers**

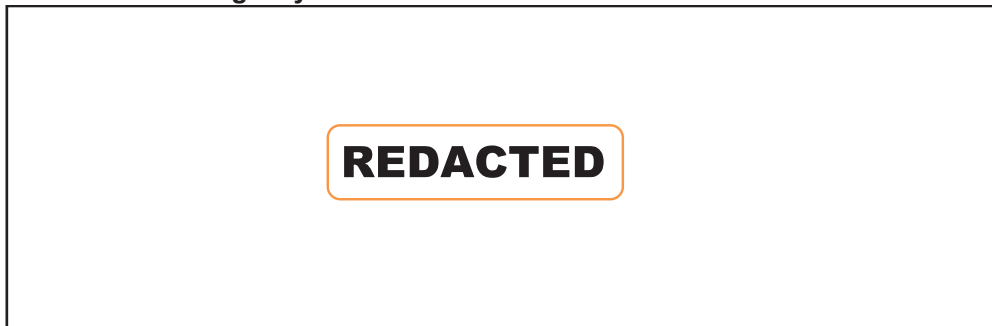

**4.4 Community Phone Numbers**

- |                   |              |
|-------------------|--------------|
| 1. Manitoba Hydro | 204-235-4371 |
| 2. Husky Oil      | 204-925-2300 |

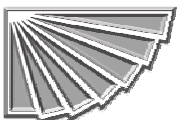

**5. Emergency Organization and Notification Procedures**

**5.1 In the event of a serious emergency, i.e. a fire, explosion, major spill or release to the atmosphere, the following people must be notified**

1. **REDACTED** *Technical Director*

Bob will have responsibility for **Media and Community Liaison**, he will also act as **“Chief Site Officer”**.

Any and all media requests must be immediately given to him for response. It is important that a uniform viewpoint be presented, and this can only be done by allowing only one spokesperson.

He, as the **“Chief Site Officer”**, will be responsible for site security, obtaining any required additional help, and will also direct queries from the authorities to the appropriate individuals below.

2. **REDACTED** *Plant Manager*

Bill will act as **“Chief Site Officer”** and **“Media and Community Liaison”** in the event that Bob is completely unavailable.

3. **REDACTED** *Plant Manager*

Bill will act as **“Emergency Action Team Chief”**, and as such will coordinate fire fighting and evacuation measures and will direct any clean up activities performed by company personnel.

He will also be responsible for all queries from the authorities regarding the physical location of hazardous chemicals, equipment, and points of access to the building.

4. **REDACTED** *Technical Service Manager*

Steve will act as **“Emergency Action Team Chief”** back-up person for all queries from the authorities regarding the physical location of hazardous chemicals, equipment, and points of access to the building. He will not act as part of the Emergency Action Team.

5. **REDACTED** *Maintenance*

The Maintenance Supervisor will act as **“Maintenance Coordinator”** and as such will be responsible for all questions from the authorities regarding electrical service to equipment, power shut-offs, water shut-offs, etc.

6. **REDACTED** *Technical Director*

Bob will act as **“Medical/First Aid Coordinator”** and as such will be solely responsible for coordinating our Emergency First Aid efforts. He will also be responsible for providing toxicity and flammability hazard data to the authorities.

**5.2 In the event of a utilities disruption the Plant Manager must be notified**

1. The Emergency Action Team Chief will coordinate any equipment or process shut down activities that are necessary.
2. If the outage occurs during working hours, the **“Emergency Action Team Chief”** will initiate evacuation procedures should they become necessary.

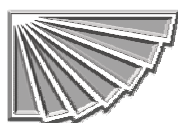

3. Should the effects of the outage become serious, i.e. a fire or spill occurs, than the procedures for serious emergencies must be followed.

**5.3 In the event of a weather emergency**

1. The “**Emergency Action Team Chief**” will coordinate any plant equipment and process shut down activities that are considered necessary.
2. The “**Medical/First Aid Coordinator**” will ensure that all Laboratory equipment and processes that present a potential hazard are shut down as well.
3. Should the weather emergency cause a fire or spill, then the serious emergency procedures must be followed.

**5.4 In the event of a threat against the Company (arson or bomb threats for example) the following people must be notified**

1. **REDACTED** *Technical Director*

Bob will have responsibility for “**Media and Community Liaison**” he will also act as “**Chief Site Officer**”.

Any and all media requests must be immediately given to the “**Media and Community Liaison**” for response. It is important that a uniform viewpoint be presented, and this can only be done by allowing only one spokesperson.

He, as the “**Chief Site Officer**”, will be responsible for site security, obtaining any required additional help, and will also direct queries from the authorities to the appropriate individuals below.

2. **REDACTED** *Plant Manager*

Bill will act as “**Chief Site Officer**” and “**Media and Community Liaison**” in the event that Bob is completely unavailable.

3. **REDACTED** *Plant Manager*

Bill will act as “**Emergency Action Team Chief**” and as such will coordinate fire fighting and evacuation measures.

He will also be responsible for all queries from the authorities regarding the physical location of hazardous chemicals, equipment, and points of access to the building.

4. **REDACTED** *Technical Service Manager*

Steve will act as the “**Emergency Action Team Chief**” back-up person for all queries from the authorities regarding the physical location of hazardous chemicals, equipment, and points of access to the building. He will not act as part of the Emergency Action Team.

5. **REDACTED** *Maintenance*

Brent will act as “**Maintenance Coordinator**” and as such will be responsible for all questions from the authorities regarding electrical service to equipment, power shut-offs, water shut-offs, etc.

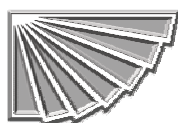

**5.5 Procedure for obtaining additional help**

1. In the event of a serious emergency during working hours, it will be the Receptionist's responsibility to act as back-up for the automatic system. If, in her judgment, there is time; she will telephone our security services company and city wide emergency services - **(9-1-1)**. After giving a brief description of the situation as she knows it, she will evacuate following the best available evacuation route.
2. If the Receptionist cannot perform this task due to the severity of the emergency, then the **"Chief Site Officer"**, or his outside designate, will assign someone to make the same two telephone calls from a safe location nearby.
3. If the emergency takes place during an evening shift, the **"Chief Site Officer"**, or his outside designate, will assign someone to make the same two telephone calls from a safe location nearby.

**5.6 Procedures for restricting entry to the site**

1. Telephone Impact Security Group: 204 -953-1965
2. Identify the Company, the address and the reason why security is required.
3. Identify the type of Security that the **"Chief Site Officer"** has asked for.

**5.7 Location of the Emergency Command Control Center**

1. The primary location for the Emergency Command Control Center will be in the south central section of the parking lot, near the south end of the parking barrier closest to the driveway.
2. The first alternate location for the Emergency Command Control Center will be in the Western Printing parking lot across Panet Road from the Cloverdale Paint's site.
3. This alternate location will only be used if there is some danger in using the primary location, but not so much that the area needs evacuating.
4. The second alternate Emergency Command Control Center will be located in the home of the **"Chief Site Officer"**. His address is: 6 Nemy Crescent, Winnipeg, Manitoba.

**6.0 Emergency Shut-Down Procedures**

**6.1 In the Event of a Fire or Spill**

**6.1.1 50 Panet Road, Manufacturing Plant**

1. Those in the immediate vicinity of the fire or spill must decide whether evacuation is necessary, using these rules:
  - a) Always sound the alarm if there is a fire and take appropriate action.
  - b) If there is a spill of flammable or toxic chemicals of 100 liters or more, sound the alarm and leave the building.
  - c) If there is a spill of less than 100 liters, do not sound the alarm. Organize clean-up activities instead.
2. Safely shut down all equipment, if possible. This includes turning off the electricity and releasing any pressure in air powered equipment.
3. If possible, Resin Plant staff will stabilize any reactions that are under way. This may involve leaving mixers running in some cases, if in their judgment that is the best way to avoid a runaway reaction.
4. All personnel have responsibility for closing the fire doors behind them as they evacuate.
5. The Receptionist and the Marketing Coordinator will call **9-1-1** and notify them of the emergency situation.

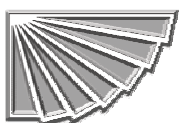



6. The Production Supervisor will pick up the time sheets on the way out, if it is safe to do so.

### 6.1.2 In the Event of a Fire or Spill - 70 Panet Road, Warehouse

1. Those in the immediate vicinity of the fire or spill must decide whether evacuation is necessary, using these rules:
  - a) Always sound the alarm if there is a fire and take appropriate action.
  - b) If there is a spill of flammable or toxic chemicals of 100 liters or more, sound the alarm and leave the building.
  - c) If there is a spill of less than 100 liters, do not sound the alarm. Organize clean-up activities instead. Notify the **"Emergency Action Team Chief"**.
2. All personnel have responsibility for closing the fire doors behind them as they evacuate.
3. Head Shipper to ensure everyone has left the building.
4. Head Shipper to call **9-1-1**.
5. Convene at 50 Panet Road. Head Office.
6. Notify Plant Manager immediately.

### 6.2 In the Event of a Threat against the Company

1. Safely shut-down all equipment, if possible. This includes turning off the electricity and releasing any pressure in air powered equipment.
2. If possible, Resin Plant staff will stabilize any reactions that are under way. This may involve leaving mixers running in some cases, if in their judgment that is the best way to avoid a runaway reaction.
3. All personnel have responsibility for closing the fire doors behind them as they evacuate.
4. The Receptionist and the Marketing Coordinator will call **9-1-1** and notify them of the emergency situation.
5. The Production Supervisor will pick up the time sheets on the way out, if it is safe to do so.

### 6.3 In the Event of a Weather Emergency

1. All personnel will safely shut down their equipment. This includes turning off the electricity and releasing any pressure in air powered equipment.
2. Resin Plant staff will complete any reactions that are under way, unless the length of time to completion makes this unsafe. In that event, they will stabilize the reactions that are under way. This may involve leaving mixers running in some cases, if in their judgment that is the best way to avoid a runaway reaction.
3. The **Plant Manager** will ensure that everyone has left, that all exit doors are locked, and will turn on the security system before leaving the building and locking up.

## 7.0 Emergency Evacuation Procedures

### 7.1 Escape Procedures and Routes

1. Each functional area within the plant and office must have its emergency escape procedures clearly posted.

These must be clearly marked with a red border indicating that they are emergency directions.

They must also be placed in areas where access to them will not be blocked at any time. This may be near a fire extinguisher to take advantage of its "red zone" or the procedures must have their own "**red zone**".



2. There must be a map indicating the escape routes described in the procedures. These maps must accompany each escape procedure poster.

**7.2 Accounting for Personnel Following an Evacuation**

1. The personnel will be divided up into functional units - the laboratory, office, shipping and receiving, canning, mezzanine, powder and resins. Each of these areas will have an assigned supervisor whose responsibility it is to count the members of his group.

Laboratory  
Office  
Shipping  
Canning  
Mezzanine  
Powder  
Sealants  
Resins



2. The group supervisors will report to the “**Chief Site Officer**” or his alternate upon the arrival of all members of the groups.
3. If an individual does not arrive at the designated meeting site, the “**Chief Site Officer**” and the “**Emergency Action Team Chief**” will decide if a search should be attempted, or they will inform the Fire Department upon its arrival.

**7.3 Emergency Warning Systems**

1. Water pressure, fire and entrance doors, and the thermostat will be monitored and equipped with alarms.
  - a) Alarms will ring internally and at ADT Security.
  - b) In an emergency situation, ADT will contact the Fire Department, Police or the After Hours Emergency Numbers.
2. There will be manual alarm pull stations plainly marked with a “red zone”, near each of the internal fire doors and near all of the emergency exits.
3. In the event of a power interruption there will be battery operated emergency lighting systems to allow for safe evacuation.

**8.0 Emergency Response Information**

**8.1 Fire Fighting Equipment - Location & Capabilities Chart**

See Drawings #2 through #4 in the Appendix A.

**8.2 Immediately Dangerous to Life or Health (IDLH) - Potential Locations Chart**

With the sole exception of the office each area of the Company should be considered as a potential IDLH site in the event of a fire in that area.

**8.3 Tank Farm**

See Drawing in Appendix B.

**8.4 Cloverdale Paint’s Raw Materials List**

See List in Appendix E.

**9.0 Flammable Goods Storage**

**9.1 Receiving**

1. See area #9 on drawing in Appendix D.
2. Storage area for finished goods.
3. Approximately 14,200 square feet of storage.
4. Minimum 11’ aisle widths.
5. Products are stored on pallets in racks three high with a maximum top bar height of 8½ feet.



**9.2 Shipping/Warehouse**

1. See Warehouse drawing #5 in Appendix A.
2. Storage area for finished goods.
3. Approximately 21,000 square feet of storage.
4. Minimum 10' aisle widths.
5. Products are stored on pallets in racks three high with a maximum top bar height of 8½ feet.

**9.3 Wet Weigh-up**

1. See area #19 on drawing in Appendix D.
2. Storage area for raw materials.
3. Approximately 5,000 square feet of storage.
4. Minimum 9' aisle widths.
5. Products are stored on pallets in racks, three high with a maximum top bar height of ten feet.

**9.4 Nitrocellulose Storage Vault**

1. See area #20 on drawing in Appendix D.
2. Storage area for drums of nitrocellulose.
3. Approximately 326 square feet of storage.
4. Product is stored on the floor and stacked a height of two drums high.

**9.5 Lab Storage Area**

1. See area #13 on drawing in Appendix D.
2. Storage area for laboratory samples and raw materials.
3. Approximately 1,000 square feet of storage.
4. Products stored on racks (bags and pails) maximum of four high.

**10.0 Building Fire Fighting Facilities**

**10.1 Fire Alarm System**

**10.1.1 50 Panet Road**

1. The control panel is located in the front entrance way at 50 Panet Road.
2. The panel is an EDWARDS #2280 ULC No. 325603 with two zones:
  - Zone 1:** Office
  - Zone 2:** Production/Labs/Receiving
3. The alarm is monitored by ADT in the event of a fire alarm the fire department is notified by ADT

**10.1.2 70 Panet Road**

1. The control panel is located on the wall when you enter the warehouse through the west side front entrance at 70 Panet Road.
2. The panel is a Notifier 500 #2280 ULC No. 325603 with one zone:
  - Zone 1:** Shipping/Warehouse
3. The alarm is monitored by ADT in the event of a fire alarm the fire department is notified by ADT.

**10.2 Emergency Exit**

1. For the locations of emergency exits at 50 Panet Road refer to drawings #2 and #3 in Appendix A and the locations of emergency exits at 70 Panet Road refer to drawing #5 in Appendix A.

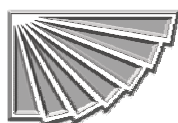

2. In order that occupants proceed with reasonable safety to exits, and to the designated place of refuge, all exit paths shall be kept free of obstructions.

**10.3 Fire Department Access**

1. At 50 Panet Road access to the fire hydrant, located by the shipping dock, and the exterior fire department hook-ups are to be kept clean of such obstructions as parked vehicles, snow and stored equipment or materials.
2. At 70 Panet Road access to the fire hydrant, located by driveway entrance on the South side of the drive way. The exterior fire department hook-ups are to be kept clean of such obstructions as parked vehicles, snow and stored equipment or materials.

**10.4 Portable Extinguishers**

1. Portable extinguishers are intended as an initial response to fires of a limited size.
2. The location of portable extinguishers in the building complex is identified with red squares.
3. The number, type and approximate location of portable extinguishers are on drawings #2 and #3 in Appendix A for 50 Panet Road. Location of the fire extinguishers at 70 Panet Road is on drawing #5 in Appendix A.

**10.5 Sprinkler System**

**10.5.1 50 Panet Road**

1. The entire building complex, including plant, labs and office areas is serviced by an automatic sprinkler system.
2. There are two fire hydrants located on the north side of the building, one by the Panet Road parking lot entrance and the other located by our receiving docks.
3. There is a Fire Department hook-up on the north side exterior wall.
4. There are no indoor hose allowances.
5. There are three wet systems, located in receiving on the north side exterior wall, consisting of two 8" systems and on 4" in-rack sprinkler system.
6. The water supply source is city with a static pressure of 76 psi and wet system pressure of 125 psi.
7. The system is monitored by both ADT (Focus 48 monitoring system) and Edwards 228 Alarm system.

**10.5.2 70 Panet Road**

1. The entire building complex is serviced by an automatic sprinkler system.
2. There is a fire hydrant located on the driveway entrance on the south side of the driveway.
3. There is a Fire Department hook-up on the south side exterior wall by the west front entrance door.
4. There are no indoor hose allowances.
5. The water supply source is city with a static pressure of 76 psi and wet system pressure of 125 psi.
6. The system is monitored by both ADT (Focus 48 Monitoring System) and Edwards 228 Alarm system.



**10.6 Exterior Fire Department Connections**

- 1. Located on the north side of the plant halfway between receiving and shipping at 50 Panet Road. At 70 Panet Road the exterior Fire Department connection is on the south wall by the west entrance door.

**10.7 Emergency Lighting**

**10.7.1 50 Panet Road**

- 1. Self contained emergency lights are located at various points in the building complex. See drawings #2 and #4 in Appendix A for locations.
- 2. The emergency lighting ensures that exits, corridors and principal routes providing access to exits are illuminated in the event of lose of normal power.

**10.7.1 70 Panet Road**

- 1. Self contained emergency lights are located at various points in the building complex. See drawings #5 in Appendix A for locations.
- 2. The emergency lighting ensures that exits, corridors and principal routes providing access to exits is illuminated in the event of lose of normal power.

**11.0 Maintenance of Fire Protection Systems and Equipment**

All Systems, Equipment, Building Features shall be maintained in operating condition, at least to the extent that they were originally intended to function.

In the event of any shut down of fire protection equipment and systems or parts there of, the following measures shall be taken:

- a) Notify ADT.
- b) Notify Fire Department.
- c) Minimize impact by ensuring that unaffected equipment, portions of sprinkler systems that are operational etc. are maintained in working order.
- d) Use watchmen where necessary utilizing walkie-talkies to ensure that all occupants and concerned parties are notified if a fire emergency occurs.

**11.1 Check, Test, Inspect Requirements For Fire Protection Systems and Equipment.**

- 1. Periodic check, test, inspections shall be made of the fire protection systems, equipment and facilities.
- 2. Records of tests and corrective measures shall be retained for a period of two years.

**11.2 Portable Fire Extinguishers**

<b>Task</b>	<b>Frequency</b>
Inspect all portable fire extinguishers .....	Monthly
Service all Portable fire extinguishers .....	Annually
Hydrostatically test carbon dioxide and water type extinguishers. ....	5 years
Empty and service stored pressure type extinguishers. ....	6 years
Hydrostatically test dry chemical and vaporizing liquid type extinguishers.....	12 years
Recharge extinguishers after use or as indicted by inspection.....	As required
Each extinguisher shall have a tag showing service date, etc.....	As required

**11.3 Fire alarm System**

<b>Task</b>	<b>Frequency</b>
Check A.C. power indicator and trouble indicator. ....	Quarterly
Test Fire alarm system including zones and standby batteries. ....	Annually
Confirm signals to ADT .....	Annually
Retain records of all tests.....	Quarterly
Inspect and service ADT's transmitting devices.....	Annually

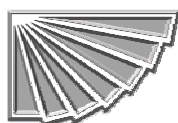

**11.4 Automatic Sprinkler Systems**

<b>Task</b>	<b>Frequency</b>
Test sprinkler transmitters and water flow activated devices .....	Annually
Test water flow alarms using inspectors test connections.....	Annually
Main drain test.....	Annually
Inspect all valves controlling sprinkler water supplies or alarms. ....	Annually
Inspect sprinkler piping and hangers.....	Annually
Inspect sprinkler heads for damage, dirt, or paint. ....	Annually
Check sprinkler cabinet for spare sprinklers and wrenches. ....	Annually
Inspect fire department connections for proper identification, operation, caps & obstructions. ....	Annually

**11.5 Emergency Lights**

<b>Task</b>	<b>Frequency</b>
Inspect and test units including terminal connections clamps and batteries.....	Annually
Test lighting duration under simulated power failure conditions. ....	Annually

**11.6 Fire Doors and Separations**

<b>Task</b>	<b>Frequency</b>
Fire separations integrity shall be maintained. ....	As required
Inspect all fire doors. ....	Monthly
Operate and inspect all fire doors including fusible links, hardware, etc. ....	Semi-annual
Maintain all means of egress including corridors and stairways.....	Monthly

**11.7 Fire Department Access**

<b>Task</b>	<b>Frequency</b>
Ensure streets, yards and private roadways are kept clear. ....	As required
Ensure access to fire department connections for sprinklers are free from obstructions at all times. ....	As required

**11.8 Tank Farm Isolation Valves**

<b>Task</b>	<b>Frequency</b>
Ensure all tank valves are in proper working order. ....	Semi-annual

**12.0 Appendix**



## **Appendix A - Equipment Location & Capabilities Charts**

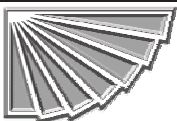



**Drawing#1**

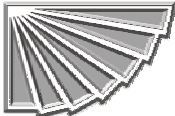
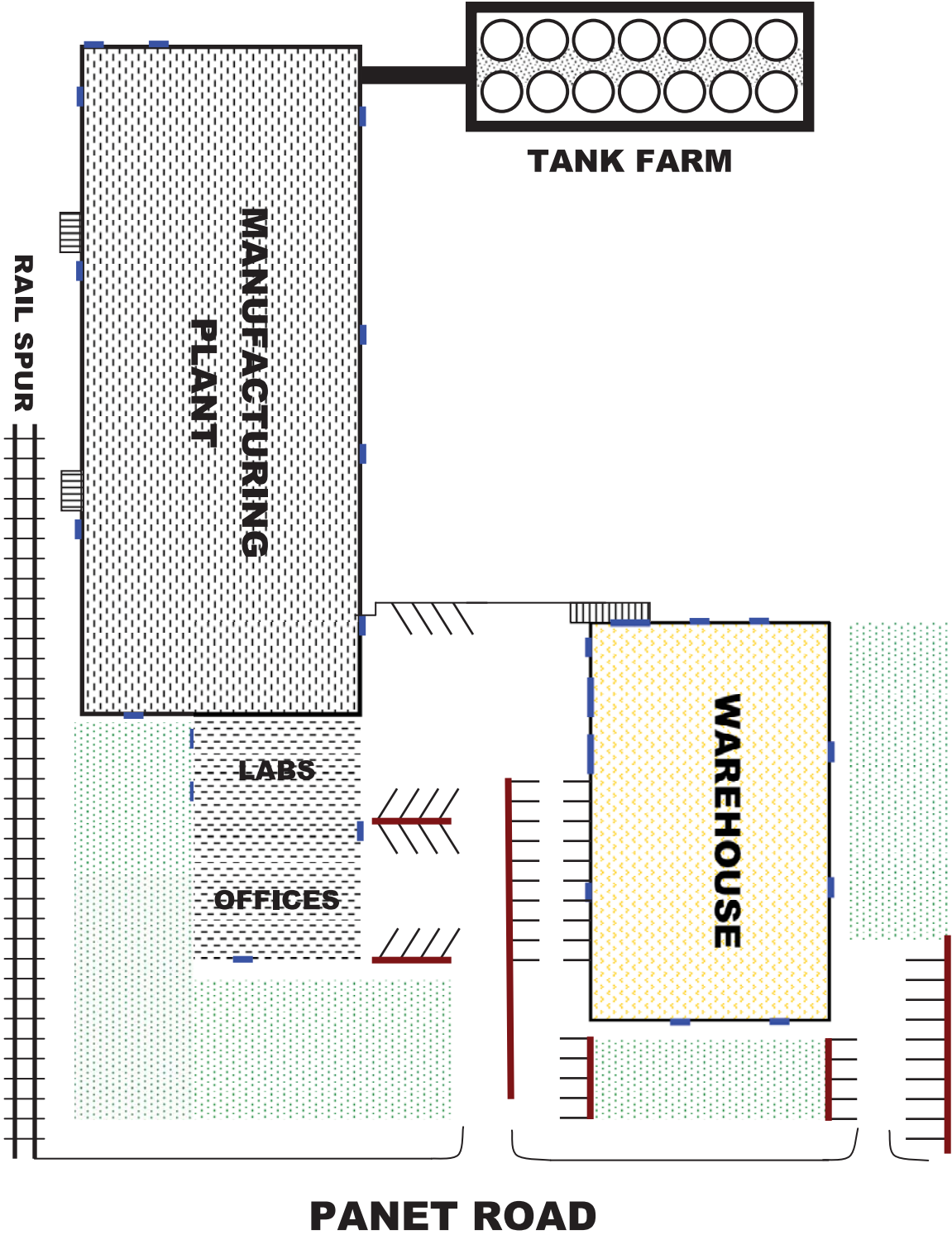



# EMERGENCY RESPONSE MANUAL

Revision #: 10

Cloverdale Paint Inc.

July 2013

## DRAWING #2

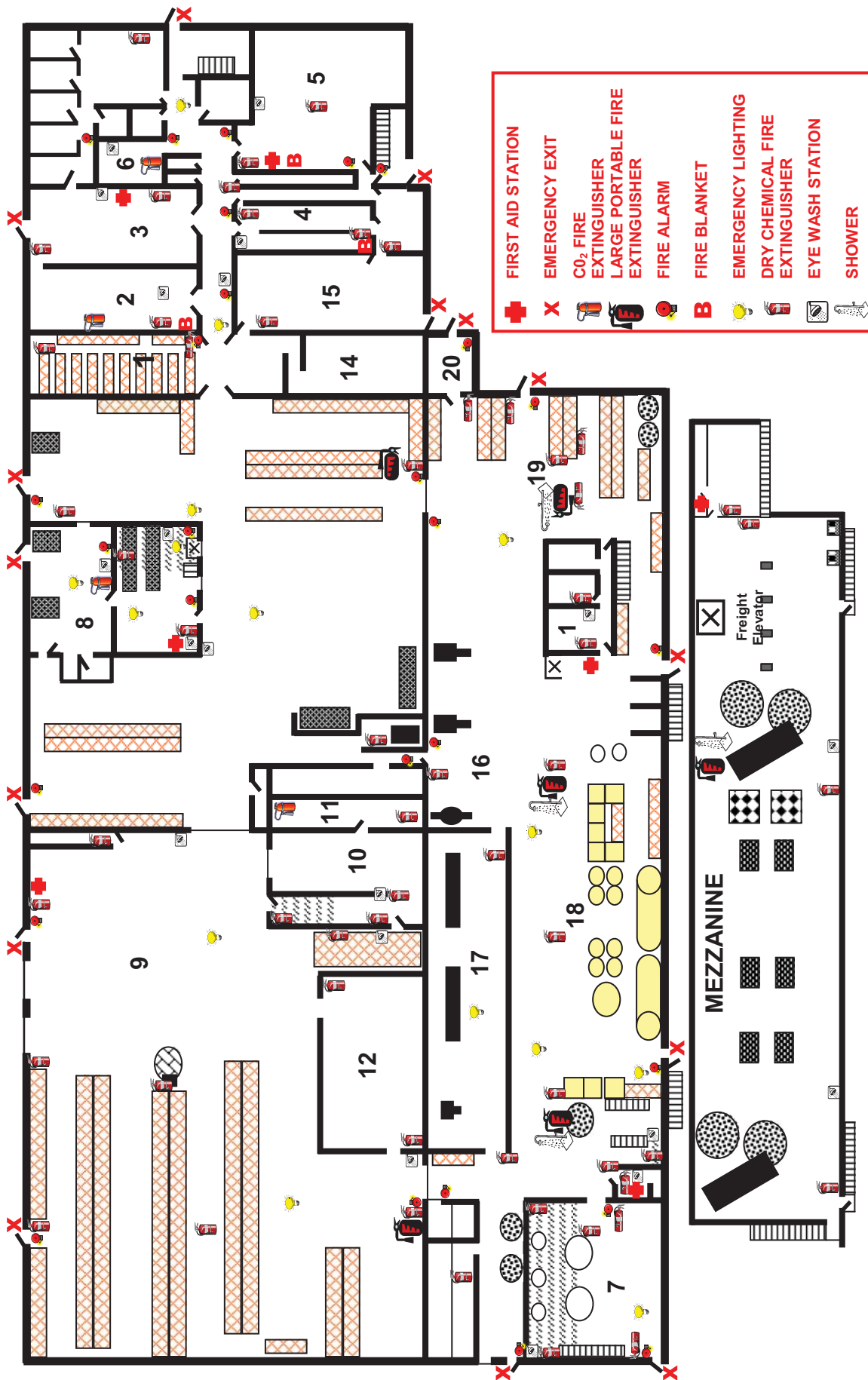

- |  |   |
|--|---|
| <ul style="list-style-type: none"> <li>1 QUALITY CONTROL LABORATORY</li> <li>4 PILOT LABORATORY (GRIND ROOM)</li> <li>7 RESIN PRODUCTION</li> <li>10 MAINTENANCE</li> <li>13 LABORATORY STORAGE</li> <li>16 SEALANTS AND TAPE PRODUCTION</li> <li>19 WET WEIGH UP</li> </ul> | <ul style="list-style-type: none"> <li>2 POLYMERS LABORATORY</li> <li>5 COATINGS LABORATORY</li> <li>8 POWDER COATINGS PRODUCTION</li> <li>11 BOILER ROOM</li> <li>14 CHANGE ROOM</li> <li>17 SEALANTS AND TAPE PACKAGING</li> <li>20 NITROCELLULOSE STORAGE VAULT</li> </ul> |
| <ul style="list-style-type: none"> <li>3 ELASTOMERS LABORATORY</li> <li>6 ANALYTICAL LABORATORY</li> <li>9 RECEIVING</li> <li>12 DRY WEIGH UP</li> <li>15 LUNCH ROOM</li> <li>18 CANNING (BENEATH MEZZANINE)</li> </ul>  |   |

# EMERGENCY RESPONSE MANUAL

Cloverdale Paint Inc.

Revision #: 10

July 2013

## DRAWING #3

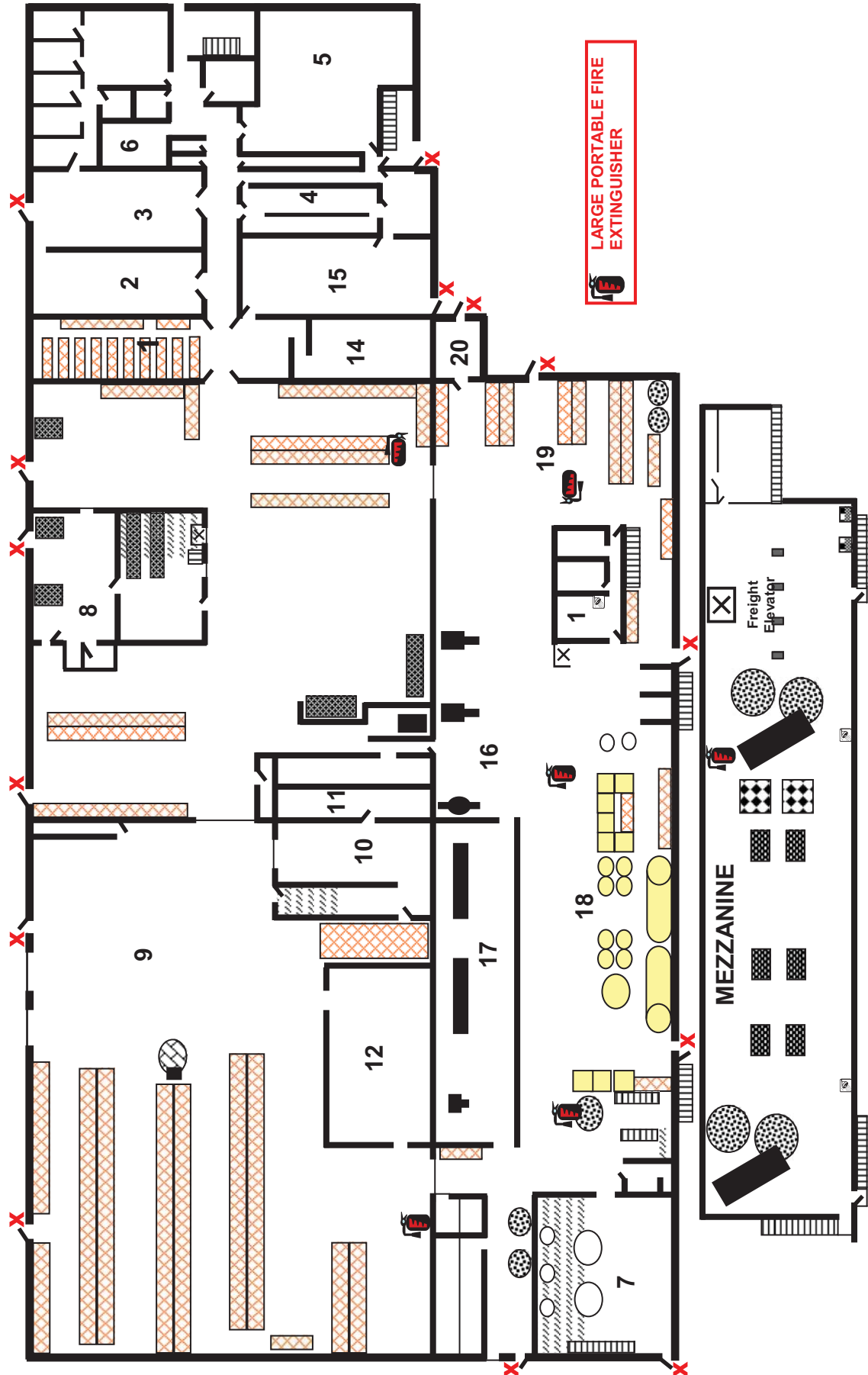

ELASTOMERS LABORATORY  
 ANALYTICAL LABORATORY  
 RECEIVING  
 DRY WEIGH UP  
 LUNCH ROOM  
 CANNING (BENEATH MEZZANINE)

3  
 6  
 9  
 12  
 15  
 18

POLYMERS LABORATORY  
 COATINGS LABORATORY  
 POWDER COATINGS PRODUCTION  
 BOILER ROOM  
 CHANGE ROOM  
 SEALANTS AND TAPE PACKAGING  
 NITROCELLULOSE STORAGE VAULT

2  
 5  
 8  
 11  
 14  
 17  
 20

1  
 4  
 7  
 10  
 13  
 16  
 19

DRAWING #4

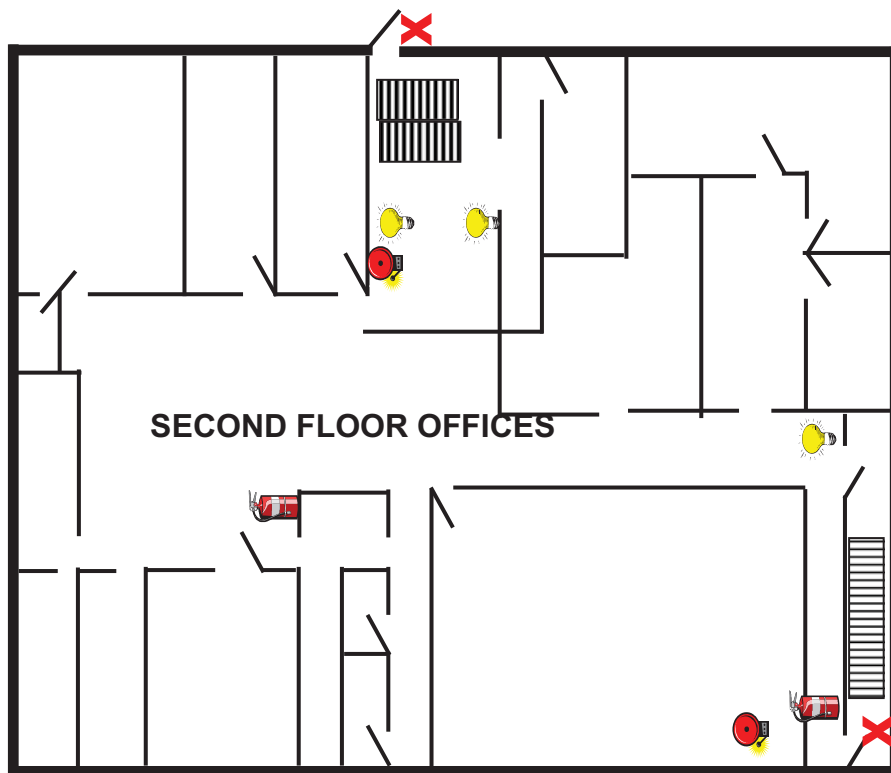
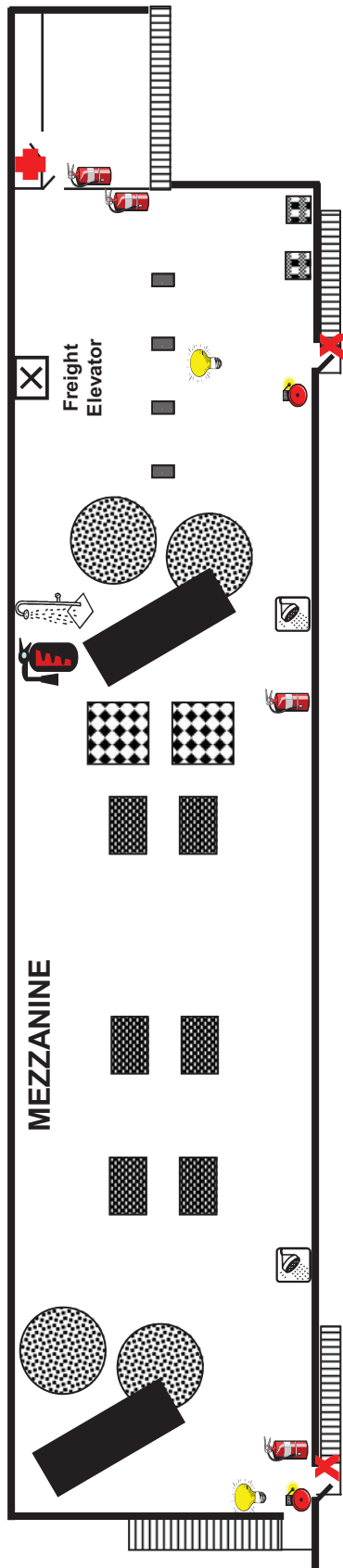

DRAWING #5

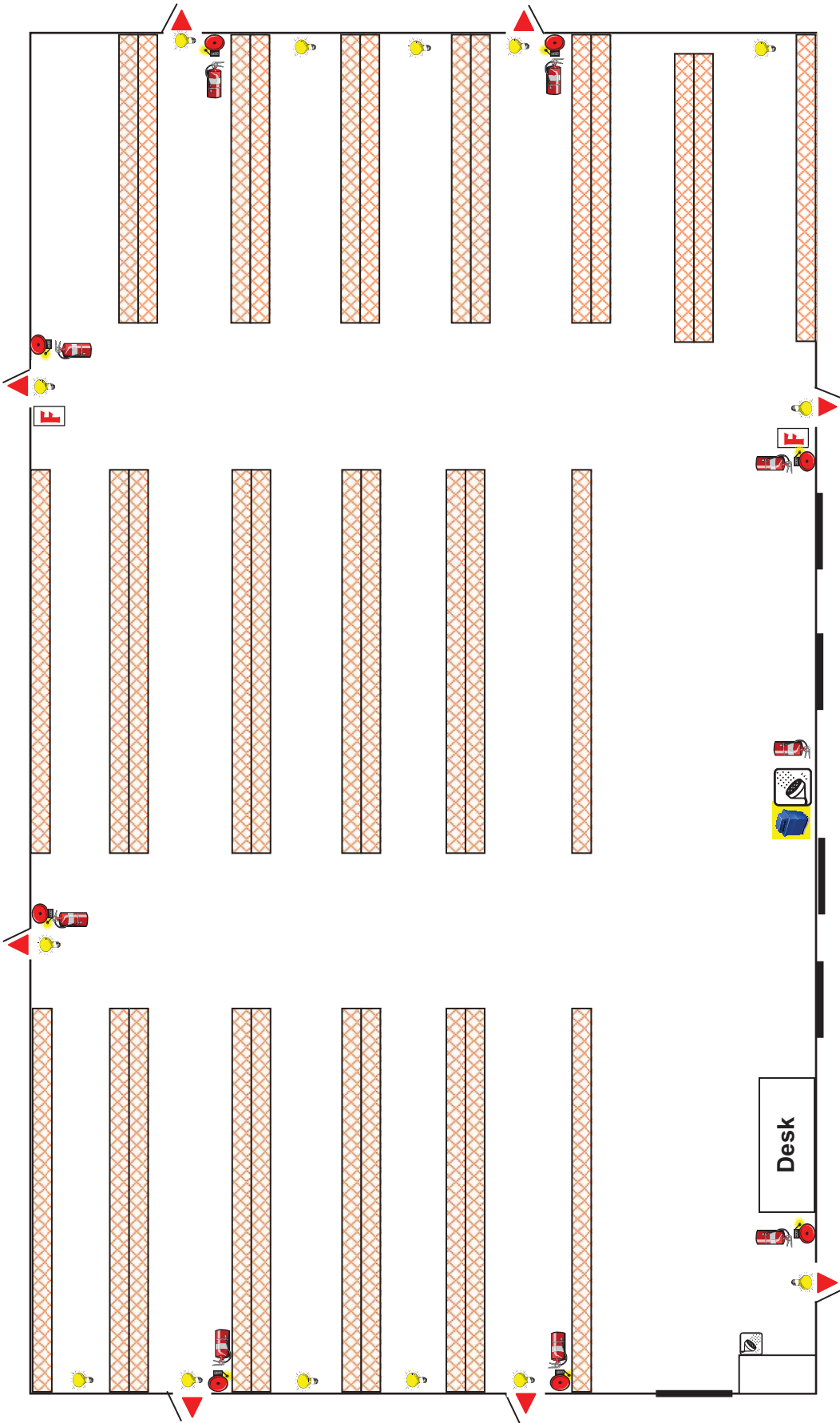

	FIRE EXTINGUISHERS
	EMERGENCY LIGHTING
	FIRE EXIT
	FIRE ALARM
	SPILL KIT
	STORAGE RACKING
	EYE WASH STATION
	FIRE HOSE



Cloverdale's Shipping / Warehouse

70 Panet Road  
Winnipeg, Manitoba

Desk

## **Appendix B - Tank Farm Drawing**

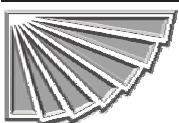

Approved for Re-posting  
 06/25/2013  
 R.G. Tinsley  
 B. Kielly

# Cloverdale Paint's Tank Farm

Note: The volumes listed are maximum capacity. The weights are the maximum for the listed product given the volume indicated.

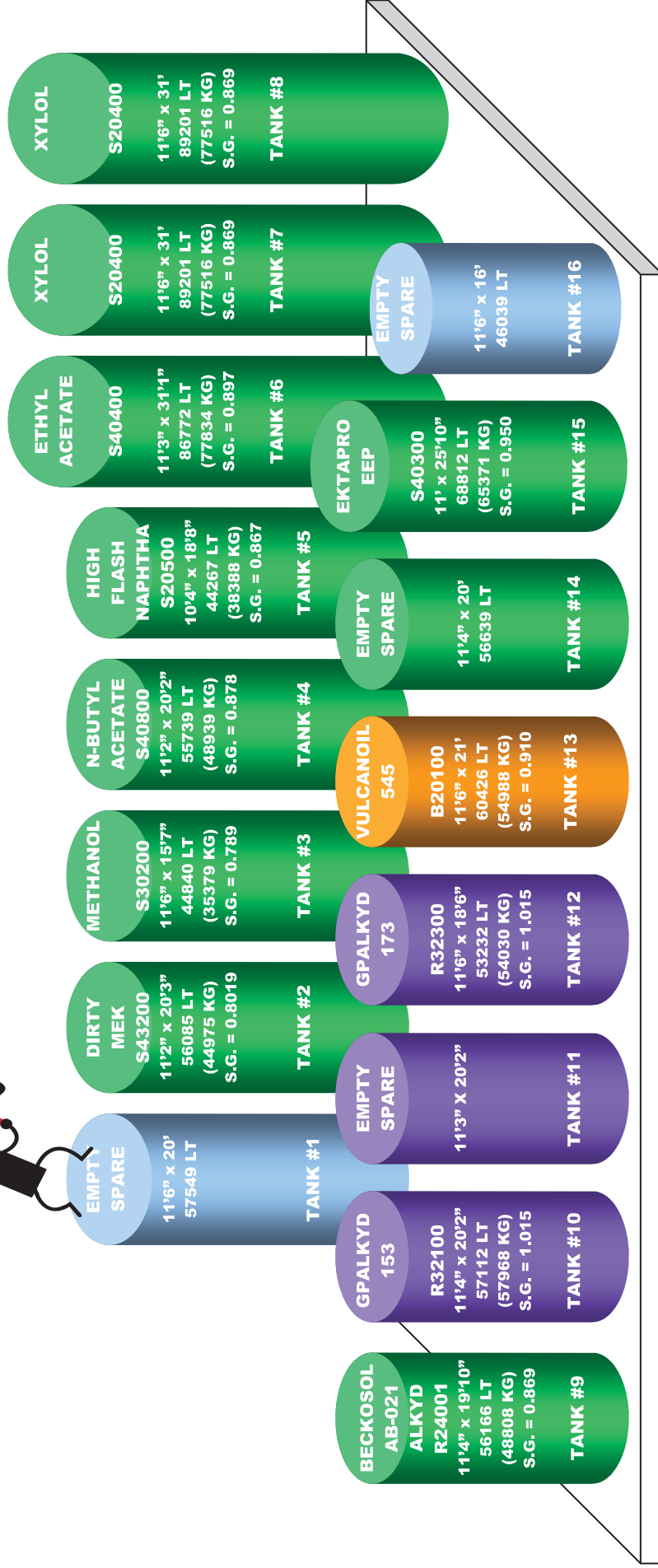

## Appendix C – Flammable Piping Drawing

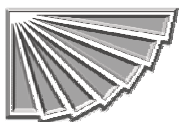



# EMERGENCY RESPONSE MANUAL

## Cloverdale Paint Inc.

Revision #: 10

July 2013

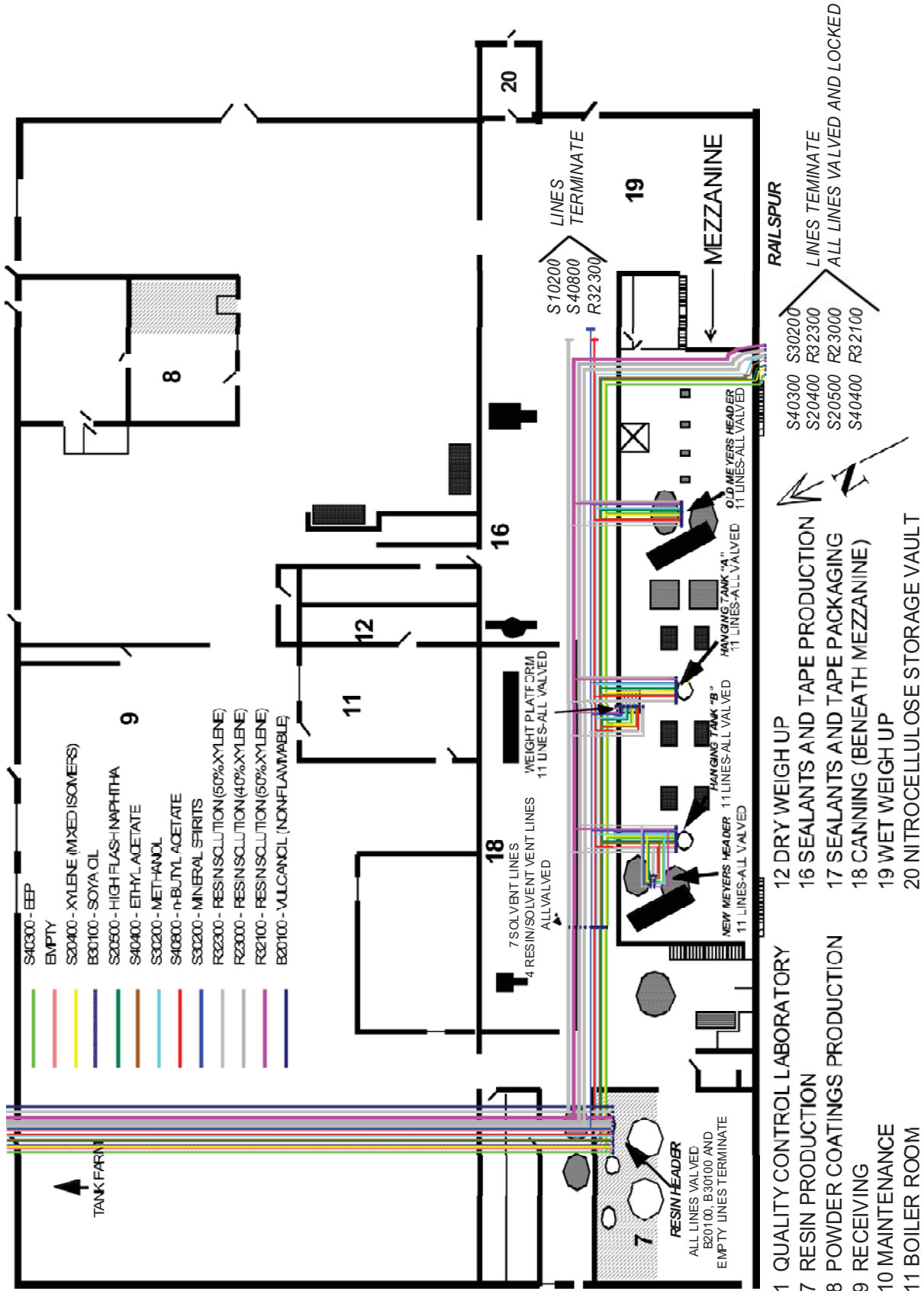

- 1 QUALITY CONTROL LABORATORY
- 7 RESIN PRODUCTION
- 8 POWDER COATINGS PRODUCTION
- 9 RECEIVING
- 10 MAINTENANCE
- 11 BOILER ROOM
- 12 DRY WEIGH UP
- 16 SEALANTS AND TAPE PRODUCTION
- 17 SEALANTS AND TAPE PACKAGING
- 18 CANNING (BENEATH MEZZANINE)
- 19 WET WEIGH UP
- 20 NITROCELLULOSE STORAGE VAULT

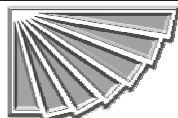



## **Appendix D – Flammable Goods Storage**

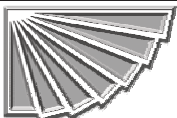

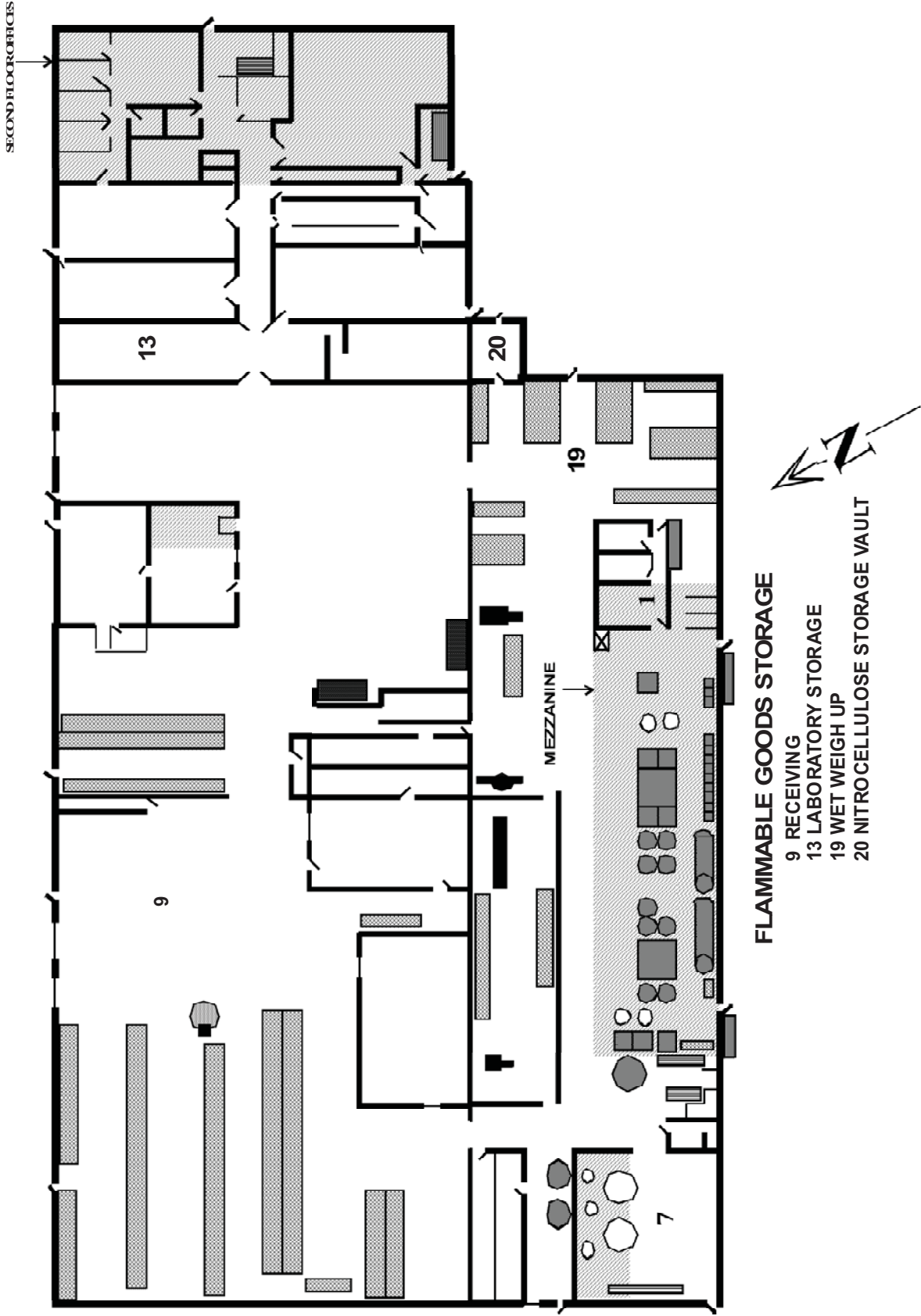

## Appendix E – Cloverdale Paint's Raw Material List

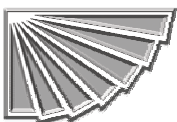

# CLOVERDALE PAINT'S RAW MATERIAL CODES

RM CODE	PRODUCT IDENTIFICATION
A10100	ANTI-TERRA-U
A10500	KTPP
A11100	TAMOL 850
A11200	NUOSPERSE-657
A11600	BYK 156
A12300	SOLSPERSE 5000
A12400	SOLSPERSE 22000
A12600	SOLSPERSE 24000
A12800	DISPERBYK - 182
A12900	DISPERBYK - 163
A13000	DISPERBYK 130
A13300	DISPERBYK - 110
A13400	LACTIMON
A13500	DISPERBYK
A13600	DISPERBYK 190
A13800	BYK 307
A14400	TEGO DISPERS 710
A14700	DISPERBYK 109
A16000	DISPERBYK 161
A16001	DISPERBYK 166
A16002	DISPERBYK 194
A16003	DISPERBYK-2000
A16004	SOLSPERSE 38500
A16005	SOLSPERSE 32500
A16006	SOLSPERSE 39000
A16007	BYK-337
A16008	DISPERBYK-140
A16009	BYK-P-104
A16010	DISPERBYK 2008
A19000	K-SPERSE 6501
A20100	AMMONIA-28%
A20200	AMP-95
A21200	TRITON CF10
A21500	TRITON X405
A22300	TEGO TWIN 4000
A23100	DUOMEEN-TDL
A23400	BYK 346
A23500	BYK 344
A23900	BYK-348
A26400	TRIETHYLAMINE
A27000	DI-ISOPROPANOL AMINE
A27001	BYK-310

RM CODE	PRODUCT IDENTIFICATION
A27002	DC200 50CST
A27003	FLUORN 561
A30600	POLYPHASE P20T
A35500	KATHON LX 1.5%
A35600	POLYPHASE P20T
A40500	BYK-052
A42400	BYK - 051
A42500	BYK-A 501
A44700	BYK-093 DEFOAMER
A45000	BYK-065
A45001	BYK-141
A45002	SURFYNOL 104DPM
A45004	BYK-085
A45006	SURFYNOL DF-62 DEFOAMER
A45008	BYK 361N
A45010	TEGO AIREX 944
A47300	BYK-024
A50100	ACTIVE 8
A50200	NUXTR-CALCIUM-6%
A50201	BORCHI OXY-COAT
A50300	NUXTR-COBALT-12%
A50400	NUXTRA-LEAD 36%
A50500	NUX-MANGANESE-9%
A50900	MEKO (EXKIN #2)
A51200	ZIRCO DRIER 24%
A51300	ZINC-NAPHTH-8%
A53000	GUAICOL SPEC. C
A53001	NUXTRA UTD-16%
A53002	ASCININ ANTI SKIN 0444
A60200	M-P-A 60 X
A60900	THIXATROL ST
A61000	ALUMINUM STEARATE
A61400	BENTONE-SD-1
A61700	ACRYSOL TT-935
A62300	BENTONE-SD-2/HF GEL 140
A62600	BENTONE-27
A62800	ACRYSOL RM-825
A62900	M-P-A 1078-X
A63600	CRAYVALLAC SUPER
A63900	ACRYSOL RM-8W
A64400	MPA-2000-X

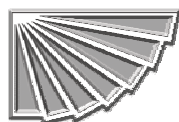

## CLOVERDALE PAINT'S RAW MATERIAL CODES

RM CODE	PRODUCT IDENTIFICATION
A64600	METHOCEL-F4M
A65300	GARAMITE 1958
A66700	DISLON 6900-20X
A68000	CAB-O-SIL LM-130
A68001	FIBER FILLER H30
A68002	CABOSIL TS 720
A68003	KAYOCEL KA650
A68005	DISPARLON PFA-231
A68006	CERATIX 8461
A68007	X-2280 IAF COMPOUND
A68008	MPA-4020 BA
A68010	NATROSOL-250MXR
A68011	BENTONE SD-3
A68012	THIXATROL MAX
A68013	BYK410
A68015	BYK-430
A68016	CERAFLOUR 996
A68018	DISPARLON 6300
A70100	BYK-300
A70400	BYK-354
A71000	SF-69 SILICONE
A71200	BYK - 306
A71300	BYK-331
A71500	MODAFLOW
A71700	BYK - 370
A72500	TEGO ADDID 900
A72700	BYK-320
A74001	LICA 38
A75000	SILAID 11
A79000	BENZOIN
A79001	RESIFLOW P67
A79002	RHEOCIN PC
A79003	LANCO WAX TF1778
A79004	UF 7001/FLUO TF 750 TX
A79005	OXYMELT A-2
A79006	OXYMELT A4
A79007	RESIFLOW PL200
A79008	CRAYVALLAC MT
A79009	CRAYVALLAC PC
A79010	BYK 364P
A79011	BYK 366P
A79012	EXPANCEL 930 DU 120
A80100	BP - DIBUTYL PHTHALATE

RM CODE	PRODUCT IDENTIFICATION
A80400	85% PHOSPHORIC ACID
A80600	ACETIC ACID 99.9%
A80800	TRIMETHYL BORATE
A81000	32% MURIATIC ACID
A81100	M&T FASCAT 4202
A81200	DIOCTYL-PHTHALATE
A81300	BUTYL BENZYL PHTHALATE
A82001	STRUKTOL-6ONS
A82002	BENZOFLEX 9-88
A82003	PALATINOL 610P
A82005	PALATINOL DPHP
A82006	MHHPA
A82007	PTSA-100
A82008	HB40 PLASTICIZER
A82009	STEARIC ACE 3964
A82013	PALATINOL 810P
A89000	ALVINOX P
A89001	POWDERMATE 542DG
A89002	CURAID 245TA-P
A89003	ES-CAT 50
A90400	TINUVIN-328
A91400	LUBRIZOL 2063
A91500	TINUVIN 292/EVERSORB 93
A91600	TINUVIN 1130
A92100	RAYBO 82
A92800	COATOSIL 2810
A95000	SILANE A-174 (MEMO)
A95001	SILANE-A-189
A95002	SILANE Z-6040
A95100	TINUVIN-770
A95101	TINUVIN-P
A95102	TINUVIN 123
A95103	IRGANOX 1010/ETHANOX 310
A96000	NACORR 1153
A96001	D0090DOWEX ION EX. RESIN HCR-S
A96002	MOLECULR SIEVE M13 BEADS
A96003	VANAX-PY
A96004	RAYBO 41
A96005	PLASTISTAB 2808
A96006	SL 551
A96007	UVITEX OB WHITENING AGT.
A96008	TYZOR TNBT
A96009	KR-38S



## CLOVERDALE PAINT'S RAW MATERIAL CODES

RM CODE	PRODUCT IDENTIFICATION
A96011	SUVA 134A
A96013	PROPANE UNDER PRESSURE
A96014	2 - METHYLPROPANE UNDER PRESSURE
A96015	KEN-REACT KZ 55
A99000	POWDER TEX 61
A99001	TROY POWDERMATE 508 TEX
A99002	POWDERTEX 100
A99003	CERAFLOUR 962
A99005	LANCO STAT 308
A99006	HALOX CW-491
A99007	SYNSLIP 3780
A99999	DRY ICE PELLETS
AN2447	ANCAMINE 2447
AN2587	ANCAMINE 2587
ARA265	AARADUR 265
ARA355	AARADUR 355
B01230	CK24000/OXY 94518
B0907-F2	CLOVALKYD 907
B0907X-F2	CLOVALKYD 907
B10000	BENZOIC ACID
B10050	2-ETHYLHEXANOIC ACID
B10200	CAPA MONOMER-CAPROLACTON
B12000	MALEIC ANHYDRIDE
B12100	ISOPHTHALIC ACID
B12300	PHTHALIC ANHYDRIDE
B12400	TRIMELLITIC ANHYDRIDE TM
B13100	TERTIARY-BU ACETOACETATE
B20100	VULCANOIL 545
B30300	BLEACHED LINSEED OIL
B30400	WOOD OR TUNG OIL
B30500	RBD COCONUT OIL
B30520	D.D. COCONUT FATTY ACID.
B42100	DIETHYLENEGLYCOL
B42700	NEXXCOAT 700
B43000	T M P - FLAKED
B43100	GLYCERINE 99.5%
B44000	PENTAERYTHRITOL
B50000	GLA ACRYLIC ACID
B50100	BUTYL AC.15-MEHQ
B50200	ROCRYL HEA 420
B50300	ETHYL ACRYLATE
B50500	1,6 HEXANEDIOL DIACRYLAT
B53400	TMPTA

RM CODE	PRODUCT IDENTIFICATION
B53800	EOPETA
B54000	GLN METHACRYL AC
B54400	H.E.M.A.-250 PPM
B54450	ISOBORNYL METHACRYLATE
B54500	A.A.E.M.
B54700	VISIOMER EHMA/MHOROMER BM-713
B54720	VISIOMER I-BMA (ISOBUTYL METHACRYLATE)/M-AM105
B57100	STYRENE MONOMER 50T
B60000	LUPEROX P-BU.PERBENZOATE
B60030	DI-TERT-BUTYL PEROXIDE
B60050	LUPERSOL 555M60
B60060	DI-T-AMYL PEROXIDE
B60200	AMICURE DBU-E
B61000	TRIPHENYL PHOSPHITE
B61200	DOVERPHOS HIPURE 4
B61600	BHT
B64000	2MERCAPTOETHANOL
B67000	LIRICINOLEATE-50
B67100	2% LITHIUM TEN-CEM
B69000	MEHQ (HQMME)
B72510	POLY THF 1000
B73000	PLURACOL P-220
B80000	I.P.D.I.
B80800	IPDI T-1890/100
B90100	DIETHYLENE TRIAMINE
B95010	ALKAMULS EL-719
B97000	CARDURA E-10
D10800	888-1045 RO
D11000	888-2009 RU
D20100	866-0018-WHITE
D20300	866-9907-BLACK
D20400	866-1810-YEL-OX
D21000	866-9494-VIOLET
D21100	866-7214-PC-BLUE
D21400	866-2825MX LF PRIM.YEL.
D21500	866-0979 LF MED. ORANGE
D22200	844-0962-MOLY-OR
D22300	844-0982-LF-ORN
D22400	844-1861-YEL-OX
D22800	844-9955-BLACK
D22900	844-0061-WHITE
D23100	844-2061-MED-YEL

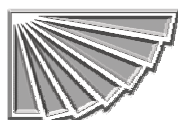

## CLOVERDALE PAINT'S RAW MATERIAL CODES

RM CODE	PRODUCT IDENTIFICATION
D23105	844-2551-LT-YEL
D23200	844-2555LF-MEDYE
D23400	844-5558PC GREEN
D23500	844-9451-VIOLET
D50100	ECKART SDF E30-B
D51500	AL.PASTE-STAPA HCP 6175
D51600	ALUM-PASTE-STAPA IL 214
D51700	STAPA IL HYDROLAN 2153
D51800	SSP-313AR AL. PASTE
D51900	ALUM-PASTE-STAMFORD O
D52000	STAMFORD A1
D52100	SPARKLE SILVER 3333-AR
D52200	SPARKLE SILVER 2750
D52300	SPARKLE SILVER ULTRA 6704 ALUMINUM PASTE
D62400	OPTICOLOR XP 4177 YO
D62500	OPTICOLOR XP 4148 QR QUINDO RED
D62700	OPTICOLOR XP4132 PB BLUE
D62800	OPTICOLOR XP4191LB BLACK
D62900	OPTICOLOR XP 4100 TW WHITE
D63400	OPTICOLOR XP4121 PG GR.
D63500	OPTICOLOR XP 4139 QV QUINDO VIOLET
D63600	OPTICOLOR XP 4112 MY
D70003	W - GEMINI WHITE TINT
D70045	ARMOURSHIELD NANO SILICA
D70097	ARMOURSHIELD FLATTING SILICA
D70166	Y0 - GEMINI YELLOW OXIDE TINT
D70180	Y - GEMINI YELLOW TINT
D70183	RY - GEMINI RED SHADE YELLOW TINT
D70190	GY - GEMINI GREEN SHADE YELLOW TINT
D70202	O - GEMINI ORANGE TINT
D70313	RO - GEMINI RED OXIDE TINT
D70317	M - GEMINI MAGENTA TINT
D70349	R - GEMINI RED TINT
D70361	RV - GEMINI RED SHADE VIOLET TINT
D70364	BR - GEMINI BLUE SHADE RED TINT
D70369	BV - GEMINI BLUE SHADE VIOLET TINT
D70531	GB - GEMINI GREEN SHADE BLUE TINT
D70540	RB - GEMINI RED SHADE BLUE TINT
D70555	SB - GEMINI SPECIAL R/S BLUE TINT
D70612	BG - GEMINI BLUE SHADE GREEN TINT
D70628	YG - GEMINI YELLOW SHADE GREEN TINT
D70710	B - GEMINI BLACK TINT
D70816	A3 - GEMINI VERY COARSE ALUMINUM TINT

RM CODE	PRODUCT IDENTIFICATION
D70817	A2 - GEMINI COARSE ALUMINUM TINT
D79933	POTLIFE EXTENDER FOR SUPERSHIELD II
D79992	MT9000 URETHANE RETARDER
D90000	REBUS 6602 YEL.OX EPOXY
D90100	REBUS 6405 BLUE EP.TINT
D90200	REBUS 6700 GR. EP. TINT
D90300	REBUS 6100 BL. EP. TINT
D90401	AQ-9050 MED YELLOW HR70 COLORANT
P10100	TIPURE R-706
P10501	ZOCO-ZINC-OXIDE
P10600	KADOX 920CO
P10700	R900-W28
P11100	TI-PURE R960
P20300	YEL-OXIDE-1420M
P21200	BAYFERROX 318M
P21900	RED IRON OXIDE 160M
P22000	RO-3097 KROMARED
P22400	RED OXIDE 222 FM
P25000	FERRITE YELLOW 2087
P25001	YLO-2288-D YELOX
P25050	SICOTRANS YELLOW L 1916
P26000	COLORTHERM 20
P26001	COLORTHERM 30 YELLOW
P26100	YELLOW HD G 9116
P26200	MAPICO HEAT STABLE TAN
P28000	CRIM-RED-OX-6098
P28001	BAYFERROX 130BM
P28002	DK-MICR-RED-130M
P28003	RO-4097 KROMA RED OXIDE
P28004	COPPERAS R. OX. R-1599D
P28005	RED IRON OXIDE R-2899D
P28050	SUCOTRANS RED L2817
P30100	DCC-1606 MOLY. ORANGE
P30101	DCC-1624 MOLY. ORANGE
P31100	DCC-1012 L.D.,MED.YEL.
P31800	HEUCOPHOS ZP-10
P32101	CHROME OXIDE GREEN GNM
P32300	NALZIN 2
P32900	HALOX SZP-391
P33900	FERRINOV-500 PIGMENT
P34000	DCC-1032 L.D. LT. YEL.
P34001	DCC-1034 LEMON YELLOW
P34002	DCC-1019 PD. MED.YEL.

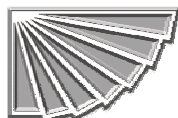

## CLOVERDALE PAINT'S RAW MATERIAL CODES

RM CODE	PRODUCT IDENTIFICATION
P34003	DCC-1080 PRIMROSE YEL.
P40900	SHEPHERD BLACK 1
P42200	PERMANENT RED FGR 70
P42300	NOVOPERM F2RK70
P43400	NOV-YELLOW-HR-70
P43500	NOV-ORANGE-HL-70
P43800	PER-ORANGE-RL-70
P44100	NAPHTHOL RED 3170
P44400	HOST. RED VIOLET ER02
P44600	RED 170 - F3RK TYPE
P44601	TRIC RED 3RKD-2/CLARIANT F3RK70
P44700	YELLOW OXIDE YLO-1888D
P47000	DCC YELLOW 7151/HOST-YELLOW-H4G
P47001	PERM. YELLOW G 11-1101
P47002	HOSTAPERM YELLOW H3G
P47003	LVL HPC-139
P47004	SUN.YELLOW 74: 272-4608
P47006	PIG. YELLOW 14 - TOPSTONE
P47009	SICO YELLOW FR-1252
P47010	LVL YELLOW 150
P47011	NOVOPERM YELLOW M2R-70
P48000	HOSTAPERM ORANGE GR
P48001	NOVOPERM ORANGE H5G 70
P48002	NOVOPERM ORANGE HL
P48003	2920 BRILLIANT ORANGE
P49000	CINQ. MAGENTA RT-355-D
P49001	VIOLET-228-5199
P49002	TRICOLITH RED 5R-2
P49004	HOSTAPERM SCARLET GO
P49005	HOSTAPERM RED D3G-70
P49006	HOSTAPERM PINK E
P49007	228-2410 SUN.MAGENTA122
P49008	NOVOPERM RED HF3S
P49009	HOSTAPERM RED E5B-02
P49010	CINQ.VIOLET R RT-101-D
P49011	HOSTAPERM RED EG
P49012	CINQ. RED Y RT-859-D
P49013	PALIOGEN RED L 3875
P49014	CROMOPHTAL VIOLET GT
P49015	PALIOGEN RED L 4045/CHROMOPHTAL RED A3B
P49017	HOST VIOLET RL SPECIAL
P49018	NAPHTHOL RED 3169
P49019	IRGAZIN RED 2030

RM CODE	PRODUCT IDENTIFICATION
P49020	IRGAZIN DPP RUBINE TR
P49023	CINQUASIA SCARLET D3070
P53200	HOST.YEL. BV01/2093
P56000	HOSTAPERM BLUE AFL
P56002	HOSTAPERM BLUE BFL
P56003	HOSTAPERM BLUE BT-617-D
P56004	PALIOGEN BLUE 6495-F
P56006	HELIOGEN BLUE L6875-F
P56007	HELIOGEN BLUE L-7460
P56008	ULTRAMARINE BLUE DRX
P56009	SUNFAST BLUE 248-0156
P56010	HELIOGEN BLUE L6870
P56011	HELIOGEN BLUE L6700F
P56012	TRICOLITH BLUE RBP
P56013	HELIOGEN BLUE L6975-F
P56014	IRGALITE BLUE GLVO
P57000	TRICOLITH GREEN GFN-4
P57001	SUNFAST GREEN 264-8142
P57002	HELIOGEN GREEN L8730
P57003	HELIOGEN GREEN L9361
P57004	MONASTRAL GREEN 6Y-C
P57005	SUNFAST GREEN 264-3120
P58000	MONARCH 120
P58001	REGAL 400R BLACK
P58002	SPECIAL BLACK 4A
P58003	MONARCH 1300 BLACK
P58004	MOGUL L
P58005	DEGUSSA BLACK FW200
P60100	IMASCO CAL.CARBONATE 6H
P60400	MICRONA 10
P61000	VICRON 41-8
P61200	HUBERCARB Q4
P61300	ALBAGLOSS
P71200	POLY GLOSS 90
P72000	SUPREX-CLAY
P80100	DIALFIL 530
P80400	IMSIL A15
P80600	OK-412
P80700	IMSIL 1240
P80800	SAFSIL CT450
P80900	DEGUSSA TS-100
P81000	ZEOTHIX 95
P81100	A0019&45,HDK-H15/AEROSIL-R972V

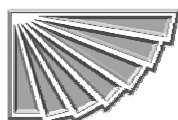



## CLOVERDALE PAINT'S RAW MATERIAL CODES

RM CODE	PRODUCT IDENTIFICATION
P81300	PROPYLTEX 50
P82000	RCF-160A/ACFT1-200 GLASS FLAKE
P82500	MIOX MICRO 20 OR 30
P83001	TALCRON MP 12-50
P83002	SILENE 732D
P83004	LO-VEL HSF
P83005	0K-520
P83006	GASIL HP-270
P83007	MARTINAL ON310
P83008	PROPYLMATTE 31
P83009	CROSSFIELD SILICA HP39
P83011	ACEMATT 3300
P85000	TALCRON MP 40-27
P85100	TALCRON MP 15-38
P90400	MICA CD2200 /C-3000
P90401	ALSIBRONZ 39
P90500	MINEX-#4
P90600	MINEX-#7
P90701	MINEX-#10
P90800	BARAMITE XF
P91300	10WOLLASTOKUP-ES
P91401	BLANC FIXE F
P91501	BARTEX 65
P92000	CALCIUM OXIDE
P92002	ACUMISTB6
P92003	MARTINAL OL-104
P92080	PCR 212 ALUMINUM POWDER
P95000	SYLOID AL-1
P95100	SYLOID ZN-1
P98000	CHROMAL IV AL. POWDER/SD30-XD
P98100	BROWN ALUMINUM OXIDE BTUS 30
P98101	ALUMINUM OXIDE C
P98155	ECKART RESIST ROTOFLEX PALE
P98300	ZINC-DUST-UP #4
R01000	CRYLCOAT 2409-0
R01001	CRYLCOAT 2494-6
R01002	URALAC P6701
R01003	SPARKLE P-6820
R01004	SPARKLE SP-940
R01010	CRYLCOAT 4430-0
R01011	SPARKLE SP-6575
R01100	CRYLCOAT 1721-0
R02000	EPOTECH YD 013

RM CODE	PRODUCT IDENTIFICATION
R02001	DOW DER642U
R04001	FINE CLAD A-249A
R04500	VESTAGON BF 1540
R05000	KOJE (TGIC)
R05001	VESTAGON B68
R05002	CASAMID 2228
R10030	LITE 2565
R10050	SILRES MSE 100
R10060	NANYA NPPN-638 NOVOLAC
R10061	ARALDITE GY289
R10062	FLEP - 60
R10070	B0390 DOW D.E.N. 438MK80
R20500	G7585 HV/BECK. AA-207
R40400	BECK 12-079/EPS 5902
R40600	EPOTUF 38-406/SE-724 EPO
R43000	ACRYLOID-B-67
R43501	BUTVAR B-79
R43502	MOWITAL B30HH
R46400	GPALKYD 464
R46401	RESYD 4100 X60
R50300	PETCOAL P120
R50500	EPODIL L/NIKANOL-Y50
R51401	NAN YA NPES 601
R51600	DOW DER 661
R52300	PICCO 6100
R53000	EPALLOY 7200
R53100	ERISYS GE-60
R53200	SHELL EPON 874-G-90
R53300	THIOPLAST EPS 25
R53400	EPODIL 742
R60102	RHOPLEX 928
R61005	UNICERE 52
R62100	PAROIL 140
R62600	CLOVAVINYL 100
R63600	JONCRYL 2561
R65100	JONCRYL 587
R70001	PARALOID-DM-55
R70002	LAROPAL-A-101
R70003	FLAKE-OR SHELLAC
R70004	ADHESION RESIN LTH
R70005	JONCRYL 611
R70006	NEOCRYL B725
R70007	FILTREZ 339

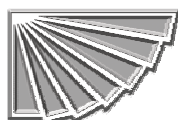

## CLOVERDALE PAINT'S RAW MATERIAL CODES

RM CODE	PRODUCT IDENTIFICATION
R70008	PARALOID B-99N
R70009	CAB 553-0.4
R70010	N/C-SS 30-35 CPS
R70020	RS 1/16 SEC NITRO.
R70030	DHX 30-50 NITROCELLULOS
R70033	32% DHX 30-50 N/C SOL.
R70050	KRISTALEX-1120
R70051	REGALREZ1018
R70052	GEON-179
R70053	GEON-136
R70054	KALAR 5275
R70055	KRATON-G1652
R70056	KRATON G1701
R70057	BUTYL BK-1675N
R70058	REGALREZ 1094
R70059	BUTYL 269-EXXON
R70060	KRYNOL 1712
R70061	OPPANOL B 10 SFN
R70062	KALAR 5215
R70063	PICCO 5140
R70064	A1101 C5 PETROLEUM RESIN
R70065	KRATON G-1726
R70066	KRISTALEX 5140
R70067	VISTANEX-MML-80/OPPANOL B80
R70068	CAB 500-5
R70069	CAB 381-2 BP
R70070	PHENADUR PR 263/70B
R70100	N/C-RS-1/4-SEC.
R70200	N/C-RS-1/2-SEC.(AN)
R70300	N/C RS 5/6
R80600	SOYBEAN OIL LV88
R80900	G 7612 EPOXY ESTER
R80901	EPI-TEX 183
R80902	GPESTER 100
R81500	DILULIN REACTIV DILUENT
R82000	DRAKEOL 19
R82001	ULTRAFLEX 22
R82100	HYPRENE 100
R82200	INDOPOL H100
R82300	PARAPOL 1900
R82400	PARAPOL H1300
R83000	CANTENEXS745/SHELLFLEX680
R83001	VIKOFLEX 7170

RM CODE	PRODUCT IDENTIFICATION
R90100	CYMEL-303
R90101	CYMEL MB-94
R90300	CYMEL U-21-510 RESIN
R90700	TES 40
R90805	SARTOMER SR368D
R90806	SETALUX 10-1440
R90813	GEMINI ARMOURSHIELD METALLIC CLEAR ACRYLIC BASE
R90815	GL093900 - GLOSS BINDER
R90816	GL0968000 MATT BINDER
R90817	SETALUX 17-1453
R91100	VEHICLE X-8020
R91800	ANCAMINE K-54
R92200	EPON 828/DER 331
R92800	SYNOCURE 890 S 55
R92900	SYNOCURE 895 S 55
R93100	PARALOID AE-1285
R93400	TOLONATE HDB 100
R93401	DESMODUR N 3200
R93402	TOLONATE HDB-75
R93403	TOLONATE HDT-LV2
R93404	TOLONATE HDT-LV
R93420	GS1058 PREPOLYMER
R93421	PREPOLYMER FOR GS02001
R93500	VERSAMID 115/ANCAMIDE 220
R93501	ANCAMIDE 220X70/VERSAMID 115X70
R93502	VERSAMIDE 100-IT60
R93503	ANCAMIDE 910
R93700	DER684EK40/EPOTUF 38-525
R94700	ANCAMIDE-260A
R94800	B0449&B0454,EPODIL 748/HELOXY8
R95002	JEFFOL S-490
R95003	SAA-100
R95008	SETALUX 27-1435
R95400	SYNOCURE 899 SA
R96000	POLYMAC 66-7093
R96100	QM1007
R96150	HARDENER VP LS 2959
R96200	VERSAMINE C 31
R96500	VERSAMINE EH50
R97500	ANCAMINE 2205
R97601	ISONATE 143-L
R97800	TOLONATE XIDT-70BA

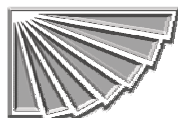

## CLOVERDALE PAINT'S RAW MATERIAL CODES

RM CODE	PRODUCT IDENTIFICATION
R98000	FLAKE WHITE SHELLAC
R98100	ANCAMINE 2458
R98400	DOWCORNING Z-6018 RESIN
R98500	DOW CORNING 840
R98501	233 FLAKE RESIN
R98502	431 HS RESIN
R98503	SR141 SILICONE
R98504	SILIKOPON EF
R98600	NPPN-638K80
R98700	ANCAMIDE 2050
R98800	NAN YA NPEF 170
R98851	ERISYS GE-36
R99001	ANCAMINE 1637
R99002	DOW DEH-52
R99003	ANCAMINE 2432
R99004	ANCAMINE 2505
R99005	ANCAMINE 2410IPA75
R99006	ANCAMINE 2280
R99007	ANCAMINE 1856
R99008	ANCAMINE 1916
R99009	EPIKURE 3233
R99010	ANQUAMINE 419 CURING AGENT
R99011	ANQUAMINE 401 CURING AGENT
R99012	ANQUAMINE 721 CURING AGENT
R99013	ANCAMIDE 2426
R99014	EK 3300/A301/IPDA
R99015	ANCAMIDE 2396
R99020	ANCAREZ AR555
R99700	ANCAMINE 2334
R99710	ANCAMINE 2422
R99720	THIOKOL LP-3
R99910	CYMEL U-663
R99931	VINYL-VYHH
R99935	LAROPAL A-81
S10200	MINERAL SPIRITS
S10600	ALIPHATIC WHT/TOLUSOL WHT
S10800	VM&P NAPHTHA
S20100	CYCLOSOL 63
S20300	TOLUOL
S20400	XYLOL
S20500	HIGH FLASH NAPHTH
S30100	ISOPROPANOL 99%
S30200	METHANOL

RM CODE	PRODUCT IDENTIFICATION
S30400	N-BUTANOL
S30500	DENAT-ETHANOL #729
S30700	SEC. BUTANOL
S30800	FURFURYL ALCOHOL
S30900	BENZYL ALCOHOL
S31200	N-PROPYL ALCOHOL
S31300	ISOBUTANOL
S40100	ACETONE
S40300	EET (2-ETHOXYETHYL PROPIONATE)
S40400	ETHYL ACETAT 99%
S40500	2,4-PENTANEDIONE
S40600	M.E.K.
S40700	M.I.B.K.
S40800	N-BUTYL ACETATE - BULK
S40801	N-BUTYL ACETATE - DRUMS OR TOTES
S40900	M.A.K.
S41100	ARCOSOLV-PMA
S41200	PNB
S41800	ISOBUTYL ISOBUTYRATE (MSDS)
S41900	EASTMAN EP
S43000	METHYL PROPYL KETONE
S43100	N-BUTYL PROPIONATE
S43200	DISTILLED MEK
S43300	N-PROPYL ACETATE
S43400	METHYL ACETATE - HIGH PURITY
S43500	DIMETHYL CARBONATE
S60100	ETHYLENE GLYCOL
S60300	PROPYLENE GLYCOL
S60500	BUTYL CARBITOL
S70000	ISO-BUTYL ACETATE (MSDS)
S70100	GLYCOL ETHER EB
S70500	PM SOLVENT
S70600	CELLOSOLVE ACETATE
S70900	DPM
S72000	CARBITOL SOLVENT
S72100	EKTASOLVE-EB-AC
S80001	TERT.-BUTYL ACETATE
S80100	METHYLENE CHLORIDE
S80200	TEXANOL
S80400	WATER
S81100	OX SOL 100
S81500	METHYL ACETATE
W00001	CAPE - CURE ACCELERATOR

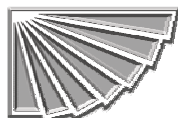

## CLOVERDALE PAINT'S RAW MATERIAL CODES

RM CODE	PRODUCT IDENTIFICATION
W00002	OMNIPAK PROPELLANT
W00056	REACTIVE ACRYLIC POLYMER
W00738	50% SAA-100 IN MAK
W02266	SPLATTER YELLOW PAINT
W03477	MONARCH YELLOW ACRYLIC ENAMEL
W04622	SPLATTER RED PAINT
W1005A	GRAIN BIN BASE SEALANT - GREY
W10220	PREMIX #1 FOR GC1022
W1022BW	BIN WHITE TINT FOR GC1022
W1022T	BUFF TINT FOR GC1022
W10300	30% SOL. 2:1 R70200/R70300 SOLUTION
W1055B	PUMP RESISTANT GLAZING TAPE - BLACK
W1064B	TEMP. RES. WINDOW TAPE - BLACK
W1064G	TEMP. RES. WINDOW TAPE - GREY
W1085B	H. TACK CONSTR. TAPE MIX - BLACK
W1085G	H. TACK CONSTR. TAPE MIX - GREY
W1085O	H. TACK CONSTR. TAPE MIX - OFF-WHITE
W1085T	H. TACK CONSTR. TAPE MIX - BUFF
W1085W	H. TACK CONSTR. TAPE MIX - WHITE
W12000	5% SF-69 SOLUTION
W12800	60% ADH. RESIN LTH IN XYLENE
W12900	60% KETONE A-101 SOLUTION
W13000	50% LAROPAL A-81 SOLUTION
W13100	60% LAROPAL A-81 SOLUTION
W13300	65% EPON 1001 SOLUTION
W13700	65% R51600 EPOXY SOL. IN MEK/BUAC
W13800	65% R51600 EPOXY SOL. IN BUAC/MEAC
W14000	40% PARALOID B-67 SOL. IN VM&P
W19000	ADHESION PROMOTING PLASTISOL
W20000	DRIED N-PROPANOL
W2005B	QUICL-TACK INSTALLATION TAPE - BLACK
W2005G	QUICK-TACK INSTALLATION TAPE - GREY
W2005T	QUICK-TACK INSTALLATION TAPE - BUFF
W2005W	QUICL-TACK INSTALLATION TAPE - WHITE
W20230	PREMIX: GC2023 & GC1023"M"
W21300	PREMIX FOR GM101200
W23800	20% SOLSPERSE 24000 IN XYLENE
W23900	20% SOLSPERSE 24000 IN ET.AC.
W24000	20% SOLSPERSE 24000 IN BU.AC.
W33000	POTLIFE EXTENDER.
W35000	70% NPES-601 IN XY/MEK
W35300	65% LAROPAL A-81 IN MEK
W39000	80% DEN 438 EPOXY NOVOLAC IN MIBK

RM CODE	PRODUCT IDENTIFICATION
W39001	80% NPPN 638 EPOXY NOVOLAC IN MIBK
W40120	BASE 4012 MONOMER
W43501	20% BUTVAR B-79 IN BUTANOL
W44000	BENTONE PRE-GEL
W44000X1	BENTONE PRE-GEL
W55000	60% SOL. DM-55 IN XYLOL
W58700	60% JONCRYL 587 SOLUTION
W60000	60% DM-55 IN PMA
W61100	45% SOLUTION, NEUTRALIZED JONCRYL 611
W63010	BLACK TINT FOR EF06301P1
W67000	50% PARALOID B67 IN XYLENE
W83002	TES-40 PREMIX
W83055	JONCRYL 587 SOLUTION
W83206	RESIN CUT FOR 83206 SILICONE
W90050	9000 LF URETHANE HI-HIDE WHITE
W90070	9000 LF S/G HI-HIDE WHITE
W90090	9000 LF WHITE
W90810	84103A - SUPERSHIELD CLEAR BASE
W90811	SUPERSHIELD HIGH SAG ACRYLIC CLEAR
W90812	CLOVALKYD 906
W91070	9000 LF YELLOW OXIDE
W91180	9000 LF LIGHT YELLOW G/S
W91210	9000 LF MEDIUM YELLOW R/S
W91710	9000 MEDIUM YELLOW R/S
W91720	9000 LIGHT YELLOW G/S
W92070	9000 LF ORANGE
W92400	9000 ORANGE
W93110	9000 LF RED OXIDE
W93190	9000 LF VIOLET
W93220	9000 LF BRIGHT RED
W93350	9000 LF F5RK RED
W93410	9000 LF VIOLET RL SPECIAL
W93540	9000 LF MAGENTA
W95050	9000 LF BLUE R/S
W95300	9000 LF BLUE G/S TINT
W95550	SUNFAST 248-1506 BLUE TINT
W96110	9000 LF GREEN B/S
W96300	9000 LF GREEN Y/S
W97050	9000 LF STERLING BLACK (AF070500)
W97060	9000 LF BLACK
W97350	9000 LF JET BLACK
W98190	9000 LF COARSE ALUMINUM



## CLOVERDALE PAINT'S RAW MATERIAL CODES

RM CODE	PRODUCT IDENTIFICATION
W98260	9000 LF FINE ALUMINUM
W99000	50% PARALOID B99 IN XYLENE
W99300	9000 LF AIRDRY CLEAR RESIN
W99440	9000 LF URETHANE ACRYLIC RESIN
W99550	9000 LF URETHANE CLEAR RESIN
W99650	9000 LF DRIER BLEND
W99880	9000 LF SUPER FLATTING PASTE

RM CODE	PRODUCT IDENTIFICATION
W99910	9000 LF URETHANE ACCELERATOR
W99980	9000 FLEET METALLIC CATALYST

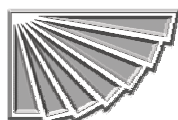

**APPENDIX D**  
**HAZARDOUS WASTE GENERATOR LICENSE**



Conservation & Water Stewardship  
Environmental Stewardship  
Environmental Services

Hazardous Waste Program

160-123 Main Street  
Winnipeg MB, R3C 1A5

### Acknowledgement of Receipt for Hazardous Waste Registration Form

This document will acknowledge receipt of the hazardous waste registration form submitted to Manitoba Conservation by the following waste consignor (generator):

Company:	Cloverdale Paint Inc.
Attention:	Bill Keilly Plant Manager
Mailing Address:	50 Panet Rd. Winnipeg, MB R2J 0R9
Date Received:	February 19th 2014
New / Supplement / Update:	New
Generation Site:	50 Panet Rd. Winnipeg, MB

The Hazardous Waste Generator Registration Number (Provincial ID No.) assigned to the above noted generation site is as follows:

**MBG13414**

In accordance with Manitoba Regulation 175/87 (Generator Registration and Carrier Licencing Regulation) pursuant to The Dangerous Goods Handling and Transportation Act, Manitoba Conservation must be notified in writing, to the above address, when there are any changes or additions to the information recorded on your registration form.

This document and the attached copy of the registration form should be retained in your files and provided to an inspector on request.

Date: May 30th 2014

Raj Rathamano  
Environment Officer  
Phone: (204)945-7086  
Fax: (204) 948-5229

RR/cb  
Enclosure



OLD LICENCE # MBG00469

**GENERATOR REGISTRATION AND CARRIER  
LICENCING REGULATION M.R. 175/87  
HAZARDOUS WASTE REGISTRATION FORM**

FEB 19 2014

Manitoba  
Conservation



Check all that apply:  New Company  Name Change  Moved  Additional Site  Update

**Section 1 Generator Identification**

Generator (Legal Name): GLOVERDALE PAINT INC. Corp. File # if app. \_\_\_\_\_  
Mailing address: 50 PANET RD. City WPG Prov. MB Postal Code R2S 0R9  
Operation Name: CLOVERDALE PAINT INC. Site Location 50 PANET RD.  
Operation Mailing Address: SAME City SAME Prov. SAME Postal Code SAME

**Section 2 Waste Description**

Physical state	TDG shipping name	PIN	TDG class	Packing group	Provincial waste class code	Quantity generated per month	Frequency of generation	Treatment/disposal code
a) L	WASTE FLAMMABLE LIQUID NOS (PAINT, METHYL ETHYL KETONE, XYLENE)	UN1993	3	II	145B	15,850KG	BC	X
b) L	WASTE FLAMMABLE LIQUID (PAINT, METHYL ETHYL KETONE, XYLENE)	UN1993	3	II	145B	3,655KG	BC	X
c) S	WASTE CORROSIVE SOLID BASIC, INORGANICS, NOS (SODIUM HYDROXIDE)	UN3262	8	II	120C	5KG	R	X
d) L	WASTE PAINT RELATED MATERIAL	UN1263	3	III	145H	2,835L	R	X

**Section 3 Waste Management Information**

General business type PAINT  
Source of hazardous waste a) BULK PAINT & SOLVENT LIQUID FROM LINE 4 VAT CLEANING b) PAINT SLUDGE c) INVENTORY WASTE-OFF  
Hazardous waste carrier(s) used CLEAN HARBORS MBG07392  
Hazardous waste receiver(s) used CLEAN HARBORS MBRO7393

**Section 4 Certification**

I certify that the information provided on this form is correct and complete.

Signature of Contact Person with the Operation: [Signature] Date (dd/mm/yy): 14/02/14  
Print Name of Contact Person: BILL KIELEY Position/Title: PAINT MANAGER  
Telephone: (204) 233-0241 Fax: (204) 233-5051

MBG 13414 Business Code \_\_\_\_\_ For department use only: RD Region Red River  
Form checked by \_\_\_\_\_ Form processed by [Signature]

Personal information is collected under the authority of The Dangerous Goods Handling and Transportation Act, Generator Registration and Carrier Licensing Regulation M.R. 175/87, and will be used to issue the Hazardous Waste Registration Number (Provincial ID number) and for administration and enforcement purposes. It is protected by the privacy provisions of The Access to Information Act and the Privacy Act. If you have any questions, contact the Access & Privacy Co-ordinator, 1383 Whyte Ave., Winnipeg MB R3E 1V7; 1-204-945-4170.



**APPENDIX E**  
**GOVERNMENT CORRESPONDENCE**

Environmental Stewardship Division  
Environmental Approvals Branch  
123 Main Street, Suite 160, Winnipeg, Manitoba R3C 1A5  
T 204 945-8321 F 204 945-5229  
[www.gov.mb.ca/conservation/eal](http://www.gov.mb.ca/conservation/eal)

File: 2743.00

May 14, 2014

Mr. Bill Kielly  
Plant Manager  
Cloverdale Paint Inc  
50 Panet Road  
Winnipeg, MB R2J 0R9

Dear Mr. Kielly:

**Re: Cloverdale Paint Inc. – Environment Act Proposal**

Thank you for the letter dated May 5, 2014 forwarded to me on your behalf by KGS Group, requesting an extension to file an Environment Act Proposal. It is indicated that Cloverdale Paint Inc contracted KGS Group Consulting Engineers to prepare and submit the proposal for the facility located at 50 Panet Road in Winnipeg.

Your request has been approved. You are required to submit a complete Environment Act Proposal by July 31, 2014.

If you have any questions regarding this matter, please contact Eshetu Beshada at (204) 945-7023 or [Eshetu.Beshada@gov.mb.ca](mailto:Eshetu.Beshada@gov.mb.ca).

Yours truly,



---

Tracey Braun, M.Sc.  
Director  
Environmental Approvals Branch

- c. Don Labossiere, Director – Environmental Compliance and Enforcement,  
Donna Smiley, Provincial Manager – Environmental Compliance and Enforcement  
Shaun Moffatt, KGS Group, Via Email: [smoffatt@kgsgroup.com](mailto:smoffatt@kgsgroup.com)

## Gene Senior

---

**From:** Friesen, Chris (CWS) <Chris.Friesen@gov.mb.ca>  
**Sent:** May-12-14 10:20 AM  
**To:** 'gsenior@kgsgroup.com'  
**Subject:** Cloverdale Paint Environmental Assessment

Gene

Thank you for your information request. I completed a search of the Manitoba Conservation Data Centre's rare species database and found no occurrences at this time for your area of interest.

The information provided in this letter is based on existing data known to the Manitoba Conservation Data Centre at the time of the request. These data are dependent on the research and observations of CDC staff and others who have shared their data, and reflect our current state of knowledge. An absence of data in any particular geographic area does not necessarily mean that species or ecological communities of concern are not present; in many areas, comprehensive surveys have never been completed. Therefore, this information should be regarded neither as a final statement on the occurrence of any species of concern, nor as a substitute for on-site surveys for species as part of environmental assessments.

Because the Manitoba CDC's Biotics database is continually updated and because information requests are evaluated by type of action, any given response is only appropriate for its respective request. Please contact the Manitoba CDC for an update on this natural heritage information if more than six months pass before it is utilized.

Third party requests for products wholly or partially derived from Biotics must be approved by the Manitoba CDC before information is released. Once approved, the primary user will identify the Manitoba CDC as data contributors on any map or publication using Biotics data, as follows as: Data developed by the Manitoba Conservation Data Centre; Wildlife Branch, Manitoba Conservation and Water Stewardship.

This letter is for information purposes only - it does not constitute consent or approval of the proposed project or activity, nor does it negate the need for any permits or approvals required by the Province of Manitoba.

We would be interested in receiving a copy of the results of any field surveys that you may undertake, to update our database with the most current knowledge of the area.

If you have any questions or require further information please contact me directly at (204) 945-7747.

Chris Friesen  
Biodiversity Information Manager  
Manitoba Conservation Data Centre  
204-945-7747  
[chris.friesen@gov.mb.ca](mailto:chris.friesen@gov.mb.ca)  
<http://www.gov.mb.ca/conservation/cdc/>

-----Original Message-----

**From:**  
**Sent:** May-06-14 10:13 AM  
**To:** Friesen, Chris (CWS)  
**Subject:** WWW Form Submission

Below is the result of your feedback form. It was submitted by WWW Information Request () on Tuesday, May 6, 2014 at 10:12:39

-----  
DocumentID: Manitoba\_Conservation

Project Title: Cloverdale Paint Environmental Assessment

Date Needed: 2014-05-30

Name: Gene Senior

Company/Organization: KGS Group

Address: 865 Waverley Street

City: Winnipeg

Province/State: Manitoba

Phone: 204 896 1209

Fax: 204 896 0754

Email: [gsenior@ksgsgroup.com](mailto:gsenior@ksgsgroup.com)

Project Description: Manitoba Conservation and Water Stewardship have determined that the alterations completed at the Cloverdale Paint facility at 50 Panet Road, Winnipeg, are a major alteration. Cloverdale Paint is required to develop an EAP for continued operation.

Information Requested: We request information regarding known locations of SAR (plant, wildlife, aquatic, etc.) occurrences in the project study area and immediate surrounding area. Please provide the specific quarter section of land for each occurrence if possible.

Format Requested: Our preference is for the data to be presented in MS Excel and ArcView formats, to be received by KGS at the email address listed in this form.

Location: 50 Panet Road, Winnipeg, Manitoba

action: Submit

-----  
-----  
No virus found in this message.

Checked by AVG - [www.avg.com](http://www.avg.com)

Version: 10.0.1432 / Virus Database: 3722/6981 - Release Date: 05/12/14

## Gene Senior

---

**From:** McClean, Heather (TCHSCP) <Heather.McClean@gov.mb.ca>  
**Sent:** May-07-14 2:27 PM  
**To:** 'Gene Senior'  
**Cc:** Smith, Brian (TCHSCP); Butterfield, David (TCHSCP)  
**Subject:** FW: Heritage Information - 50 Panet Road, Winnipeg

Hi Gene – There are no known heritage resources located within your specified project area.

Thank you.

### Heather McClean

Heritage Resources Registrar  
Historical Assessment Services  
Historic Resources Branch  
Main Floor, 213 Notre Dame Avenue  
Winnipeg MB R3B 1N3  
[Heather.McClean@gov.mb.ca](mailto:Heather.McClean@gov.mb.ca)  
Phone: (204) 945-7146  
Fax: (204) 948-2384

---

**From:** Smith, Brian (TCHSCP)  
**Sent:** May-06-14 1:26 PM  
**To:** 'Gene Senior'; McClean, Heather (TCHSCP)  
**Subject:** RE: Heritage Information - 50 Panet Road, Winnipeg

Gene, I am passing your request on to Heather McClean, our Heritage Resources Registrar who undertakes to supply this type of information. Thank you Heather. -Brian

Brian J. Smith  
Manager, Archaeological Assessment Services Unit  
Historic Resources Branch  
213 Notre Dame Avenue, Winnipeg, MB R3B 1N3  
Phone (204) 945-1830; Fax (204) 948-2384  
E-mail: [Brian.Smith@gov.mb.ca](mailto:Brian.Smith@gov.mb.ca)

---

**From:** Gene Senior [<mailto:GSenior@ksgsgroup.com>]  
**Sent:** May-06-14 12:22 PM  
**To:** Smith, Brian (TCHSCP)  
**Subject:** Heritage Information - 50 Panet Road, Winnipeg

Mr. Brian Smith,

KGS Group is conducting an Environmental Act Proposal for Cloverdale Paint. We are looking to identify heritage and archaeological resources which may be impacted by the project. The project is located at 50 Panet Road in Winnipeg.

We are requesting a location and description of each, if any, resources located on or near the land as shown on the attached map. Additionally, we are requesting the data delivered in Excel and ArcView format (or PDF mapsheet).

Thank you for your assistance.

Sincerely,

**Gene Senior** ([gseior@kgsgroup.com](mailto:gseior@kgsgroup.com))

Environmental Scientist



865 Waverley Street  
Winnipeg, Manitoba R3T 5P4  
p. 204.896.1209 ext. 357  
c. 204.218.3285  
f. 204.896.0754  
<http://www.kgsgroup.com>



**Go Green:**  
**Think before you print**

This email and any attachments are for the sole use of the intended recipients and may be privileged or confidential. Any distribution, printing or other use by anyone else is prohibited. If you are not an intended recipient, please contact the sender immediately, and permanently delete this email and attachments.

---

No virus found in this message.

Checked by AVG - [www.avg.com](http://www.avg.com)

Version: 10.0.1432 / Virus Database: 3722/6976 - Release Date: 05/11/14