

**PLAN VIEW**

SCALE 1:30

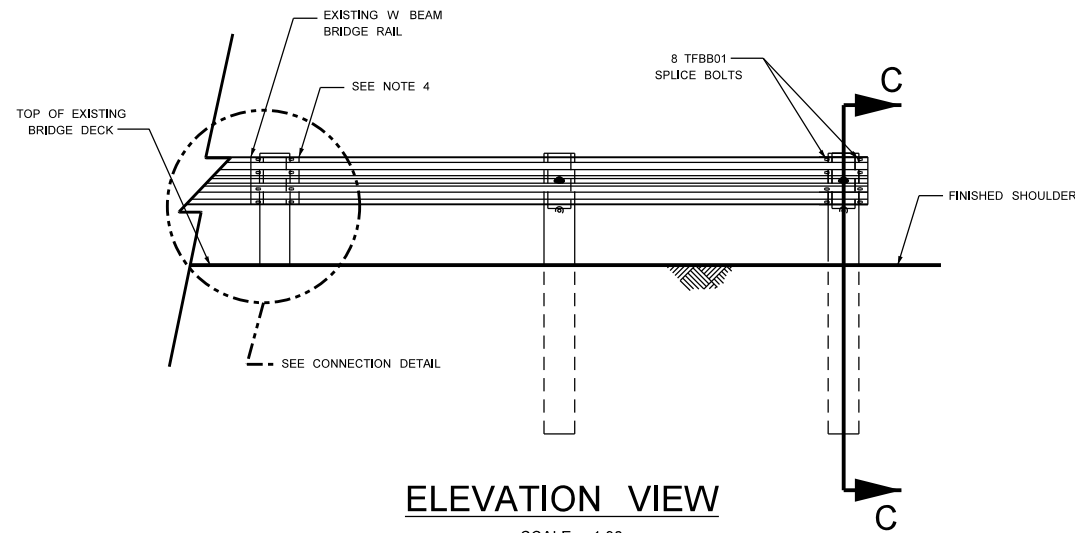

**ELEVATION VIEW**

SCALE 1:30

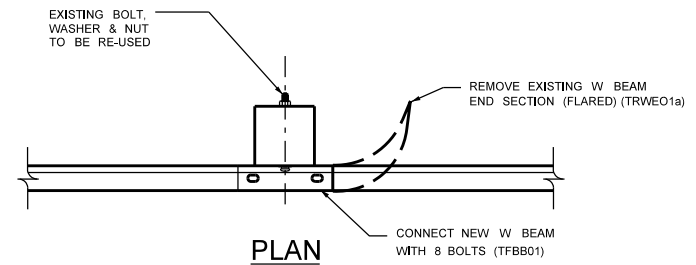

**PLAN**

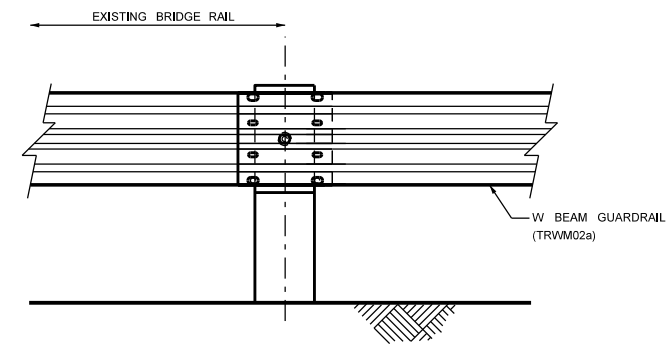

**ELEVATION**

**CONNECTION DETAIL**

SCALE 1 : 15

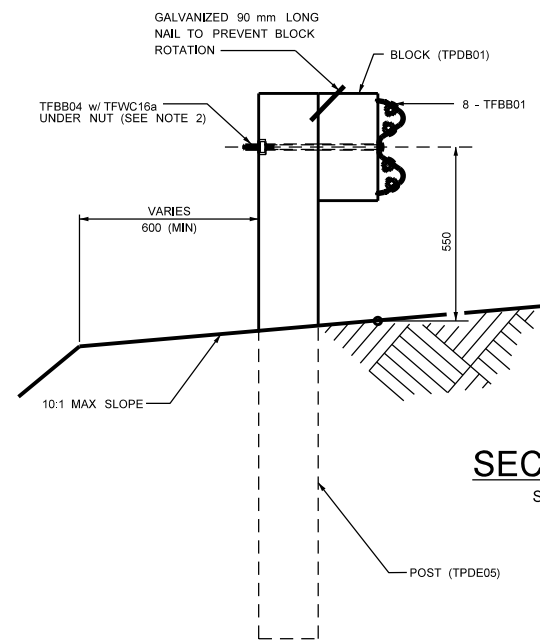

**SECTION C-C**

SCALE 1 : 15

**NOTES:**

1. ALL MEASUREMENTS ON THIS SHEET ARE IN MILLIMETRES UNLESS NOTED OTHERWISE.
2. CUT / GRIND POST BOLT AS REQUIRED TO FACILITATE ASSEMBLY.
3. TRANSITION FROM EXISTING RAILPOST HEIGHT TO THE REQUIRED GUARDRAIL DESIGN HEIGHT (NOTE SECTION C-C ) SHALL OCCUR WITHIN THE FIRST W BEAM GUARDRAIL SECTION.
4. GUARDRAIL TO BE LAPPED FOR TRAFFIC APPROACHING BRIDGE BOTH SIDES OF ROADWAY.

REVISIONS		
DATE	DESCRIPTION	BY

**Manitoba**   
**Infrastructure and Transportation**  
 TRAFFIC ENGINEERING



W BEAM APPROACH  
 GUARDRAIL TO W BEAM  
 ON TREATED TIMBER  
 BRIDGE TRANSITION

SHEET NO	1 OF 1
DATE:	2011 - 04
DRAWN:	TRAFFIC ENGINEERING
<b>TSTB13</b>	