

R.M. OF CARTIER

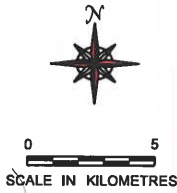

PROVINCE OF MANITOBA
INFRASTRUCTURE
HIGHWAY PLANNING AND DESIGN BRANCH
GEOGRAPHIC & RECORDS MANAGEMENT SECTION
WINNIPEG
JANUARY 1, 2015

REVISED: APRIL 2015

LEGEND

TRANS-CANADA HIGHWAY		ACCESS ROADS	
PROVINCIAL ROADS		RAILWAYS	

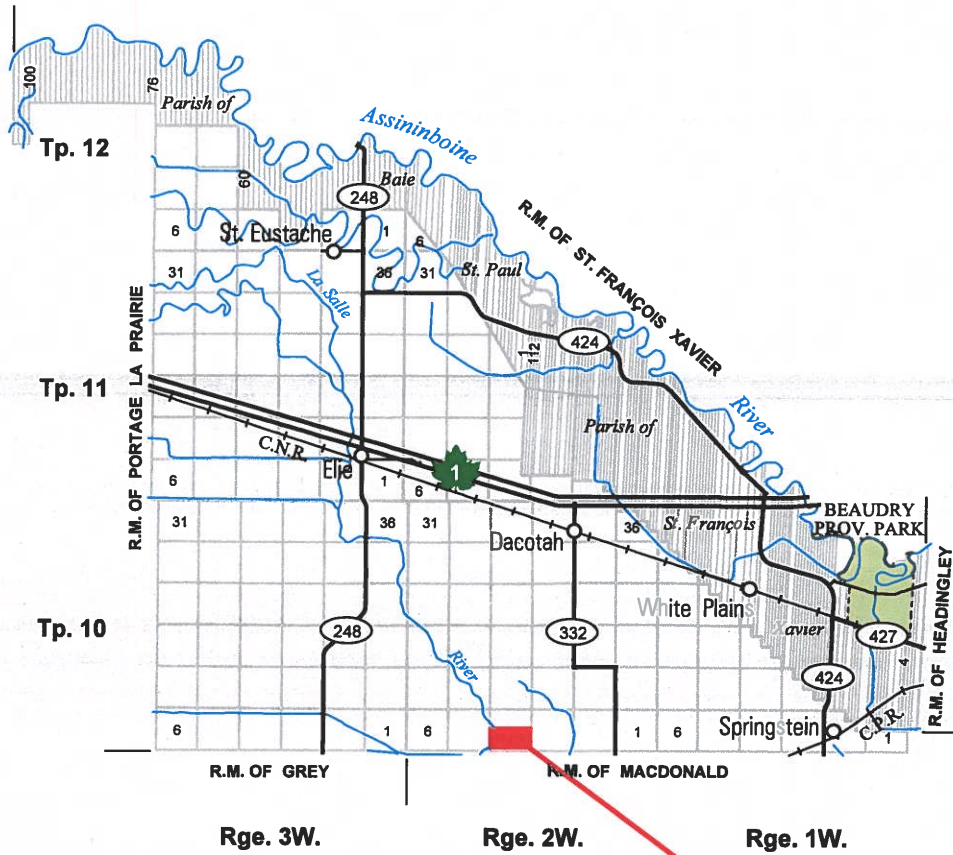

**Starlite Colony
SE 4-10-2W
RM of Cartier**

Project Site