

Rural Municipality of Ste. Anne

395 Traverse Road, Box 6 Grp 50 RR1, Ste. Anne, MB R5H 1R1

Phone No: (204) 422-5929 Fax No: (204) 422-9723

Registered Property Owner

Name: Rising Hope Dairy Inc.
Address: Box 49, Landmark, MB R0A 0X0
Phone No/Cell: 204-355-4980/204-371-5744
Email: n/a

File No.: C.U./T.R.C.# 05-15
Roll No.: 119300.000

Applicant if different from owner

Name: Alvin Plett
Address: Same as above
Phone No/Cell:

Application Fee: TRC - \$750.00
Receipt No: 20150342

Location & General Description of Land

Zoning: A	Lot size: 147.34 acres	Ward: 5
Lot: n/a	Block: n/a	Plan: n/a
Section: Pt. NW ¼ 30-8-6E	Civic: 46093&46107 Rd. 30E	

EXISTING:

2 single-family dwellings with attached garages, detached garage, dairy barn, workshop, Silo, earthen slurrystore system, pole shed, 2 loose housing, hay shelter, modern dairy barn. Currently operating a livestock dairy operation to a maximum of 450 animal units, as per Permit #20-12, approving Resolution #178-12.

PROPOSED:

Expansion of existing livestock dairy operation to greater than 200 animal units (from the current 450 animal units to up to 1200 animal units)

Comments:

Application Type
Conditional Use X
Information Required
Letter of Intent <input checked="" type="checkbox"/>
Bldg location Cert.
Owner's consent Letter

Applicant's Signature: I/We hereby certify that the information provided on this form and attachments hereto, to the best of my/our knowledge is a true statement of facts concerning this application.

Signature: 	Date: April 24, 15
--	--------------------

Application Received by: 	Date: April 24, 2015
--	----------------------

By-Law # 10-2010 as amended
Part: VI
Section: Part 3 Section 3.0
Table: VI-5
Planning Act Section: Part 7, Division 2

OFFICE USE ONLY – PLANNING & BLDG COMMENTS
HEARING:

The Conditional Use shall expire if not acted upon within 12 months of the date approved.

Good Evening Councillors,

We, Rising Hope Dairy, want to make you aware about our intentions to increase our manure units from 450 to 1000AU - with the new waste unit calculations this is technically 1200 AU. Upon the advice from a wise councillor here at St. Anne, we thought it would a good idea to sit down and dialogue with you all before we engage with the technical review. Past experience tells us that to stay in communication with everyone is only to our advantage. The reason that we are wanting to increase our manure units dates back to wanting to bring our cattle home from other locations. We have found that unless we are taking care of our own cattle, they suffer greatly. We are again coming to a situation where we will have to ship some of our cattle to a different location to stay within our allowable waste units, however, this does not sit well with us. It was sad to see healthy cattle go out and come back skinny and sickly. Kevin and Connie, and Paul and I both have young large families that are excited about farming and love being part of the farm. We have chosen to invest in farming because it fulfills our interests, giftings and passions with in our family and community.

Since purchasing the Graham Jones farm in December of 2009, we have enjoyed getting to know the neighbours around us and rubbing shoulders with them. Together, with our farming neighbours, we have sought to work to improve drainage going west in our area. We trust that people have found us quite cooperative, approachable, seeking to be good neighbours, and conscientious citizens.

It was a pleasure to purchase the farm from Mr. Jones and move into a new, up-to date facility with some unique European ideas that we were foreign to. Since the purchase, we have also endeavoured to make several improvements of our own to the farm. These improvements include cleaning up a lot of garbage and old fence lines on fields. We filled in a huge water hole that was used to harvest fill for the new barn the Jones family built. We built a new barn to house some of the outside cattle. We have purchased manure pumping equipment so that all liquid manure is pumped to the field with a drag line to be more neighbourhood friendly and also a lot easier on the roads. We file our manure management every year and have passed a random audit with flying colors.

At Rising Hope Dairy it has been exciting to see some of our employees rise to the challenge of achieving Gold Medal Status for milk quality. Only 10% of milk producers in the province have achieved this standard. We have sought to be more visible in the community, providing free chocolate milk at tournaments, allowing the free use of our equipment and fuel for installations of a few play structures in Landmark, supporting community projects financially etc. We have also added 160 Acres to our land base there. Just last week we planted 700 trees on the north and south sides of the farm. We are considering pouring a large cement pad on the east side of the farm for all our silage storage this summer. Why are we telling you this? We want you to be aware that we are doing our best to operate a well-run, conscientious dairy farm.

In light of our plans to increase our animal waste units, we have approached many of our neighbours and so far have received good responses. All the land that we are including in this technical review is within 3 miles of the farm. This is very exciting for us, because it means that all land can be reached with our manure drag line.

At this point, we are here to open up a dialogue and willing to listen to your thoughts and attempt to answer whatever questions you might have.

Rising Hope Dairy

C/O Kevin and Connie Plett and family

Paul and Cheryle Warkentine and family

Alvin and Katherine Plett



cleaned up a lot of garbage
 cleared water hole
 cleared old lagoon + built new one.
 Improved drainage going west
 Have supported various community projects
 always file manure management + been audited
 We pump our manure thru a hose (no auger to equip)
 This farm is in Gold Medal status
 We have added to land have extra 160 A

Going Forward

- Plant Shelterbelts
- Build Silage Bunkers
- Ask for and increase in water units

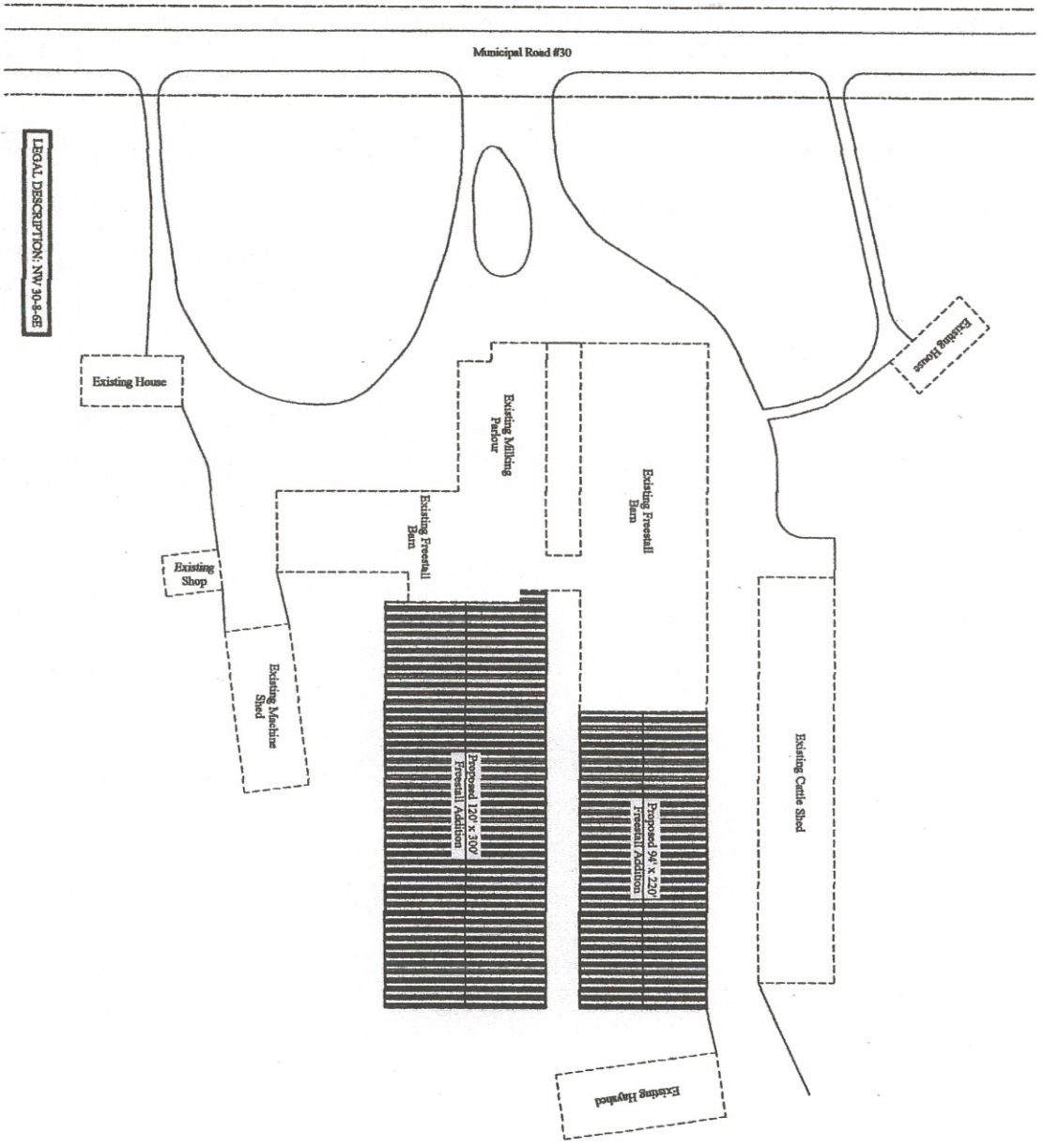

Pnfol
Constructio

215 S. Blinnwood, Middleburg Heights, OH 44130
Phone: (216) 227-7711 Fax: (216) 227-7712
www.pnfol.com

Rising Hope Fa
Proposed Freezall Barn Addi
Landonck, MB

Siteplan	
Date	Revised By
Feb. 11, 2015	JT
As noted	RD